

PUBLIC WORKS DEPARTMENT PROJECTS

(Street Projects)

PROJECT TITLE: Queens Rd., 6th St. to Peterson Rd. (N 1700 Rd.)

DEPARTMENTAL RESPONSIBILITY: Public Works

Description: Reconstruct the existing gravel road to a 36-foot wide collector street (12' vehicle lanes and 4' bike lanes) with sidewalks on both sides from Sixth Street to Peterson Rd. (N 1700 Rd.)

Justification: The street is too narrow to accommodate current and projected traffic volumes along the corridor and does not meet city standards.

Comments: Additional right-of-way may be required. Cost is unknown at this time.

EXPENDITURE SCHEDULE (\$000,S)									
PROJECT ELEMENT	TOTAL	THRU 2004	2005	2006	2007	2008	2009	2010	BEYOND 2010
PLANNING									
DESIGN	211					211			
LAND									
CONSTRUCTION	2112					2112			
EQUIPMENT									
2% FOR ARTS									
OTHER									
TOTAL	2323					2323			

FUNDING SCHEDULE (\$000,S)									
SOURCE	TOTAL	THRU 2004	2005	2006	2007	2008	2009	2010	BEYOND 2010
G. O. BONDS	1161					1161			
SPECIAL ASSMT.	1162					1162			
REVENUE BONDS									
CURRENT REV.									
FEDERAL AID									
STATE AID									
EX. BONDS									
OTHER									
TOTAL	2323					2323			

PROJECT TITLE: Folks Rd., Trail Rd. to Peterson Rd.

DEPARTMENTAL RESPONSIBILITY: Public Works

Description: Reconstruct the existing gravel road to a 36 foot wide collector street (12' vehicle lanes and 4' bike lanes) with sidewalks on both sides from Trail Road to Peterson Rd. (N 1700 Rd.)

Justification: The street is too narrow to accommodate current and projected traffic volumes along the corridor and does not meet city standards.

Comments: Additional right-of-way may be required. Cost is unknown at this time.

EXPENDITURE SCHEDULE (\$000,S)									
PROJECT ELEMENT	TOTAL	THRU 2004	2005	2006	2007	2008	2009	2010	BEYOND 2010
PLANNING									
DESIGN	160				160				
LAND									
CONSTRUCTION	1600				1600				
EQUIPMENT									
2% FOR ARTS									
OTHER									
TOTAL	1760				1760				

FUNDING SCHEDULE (\$000,S)									
SOURCE	TOTAL	THRU 2004	2005	2006	2007	2008	2009	2010	BEYOND 2010
G. O. BONDS	1760				1760				
SPECIAL ASSMT.									
REVENUE BONDS									
CURRENT REV.									
FEDERAL AID									
STATE AID									
EX. BONDS									
OTHER									
TOTAL	1760				1760				

PROJECT TITLE: W. 6th Street, Arkansas Street to Massachusetts Street

DEPARTMENTAL RESPONSIBILITY: Public Works

Description: Mill and overlay the existing street and replace curb and gutter sections as needed from Arkansas Street to Massachusetts Street.

Justification: The existing pavement and sections of the curb and gutter show significant signs of deterioration. The project is necessary to maintain a safe and efficient arterial street system.

Comments:

EXPENDITURE SCHEDULE (\$000,S)									
PROJECT ELEMENT	TOTAL	THRU 2004	2005	2006	2007	2008	2009	2010	BEYOND 2010
PLANNING									
DESIGN	60		60						
LAND									
CONSTRUCTION	540		540						
EQUIPMENT									
2% FOR ARTS									
OTHER									
TOTAL	600		600						

FUNDING SCHEDULE (\$000,S)									
SOURCE	TOTAL	THRU 2004	2005	2006	2007	2008	2009	2010	BEYOND 2010
G. O. BONDS	400		400						
SPECIAL ASSMT.									
REVENUE BONDS									
CURRENT REV.									
FEDERAL AID									
STATE AID	200		200						
EX. BONDS									
OTHER									
TOTAL	600		600						

PROJECT TITLE: Wakarusa Drive, South of Clinton Parkway to the SLT

DEPARTMENTAL RESPONSIBILITY: Public Works

Description: Construct additional lanes on the west side of the existing street from Clinton Parkway south to the SLT. Widen at intersection with SLT and 27th Street.

Justification: This roadway serves new residential and commercial developments as well as a connection to the SLT.

Comments:

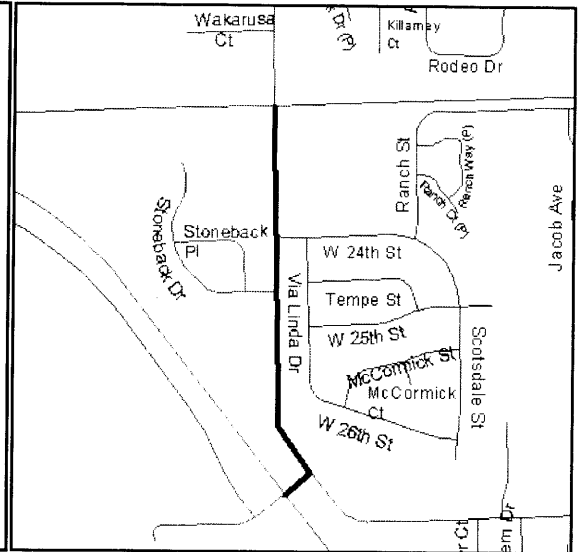

EXPENDITURE SCHEDULE (\$000,S)									
PROJECT ELEMENT	TOTAL	THRU 2004	2005	2006	2007	2008	2009	2010	BEYOND 2010
PLANNING									
DESIGN	50			50					
LAND									
CONSTRUCTION	300			300					
EQUIPMENT									
2% FOR ARTS									
OTHER	45			45					
TOTAL	395			395					

FUNDING SCHEDULE (\$000,S)									
SOURCE	TOTAL	THRU 2004	2005	2006	2007	2008	2009	2010	BEYOND 2010
G. O. BONDS	195			195					
SPECIAL ASSMT.									
REVENUE BONDS									
CURRENT REV.									
FEDERAL AID									
STATE AID	200			200					
EX. BONDS									
OTHER									
TOTAL	395			395					

PROJECT TITLE West 31st Street, Ousdahl Road to Louisiana Street

DEPARTMENTAL RESPONSIBILITY: Public Works

Description: Reconstruct the existing chip and seal roadway to a four-lane arterial with median and sidewalks on both sides from Ousdahl to Louisiana.

Justification: This roadway is an old chip and seal roadway that has had 2" asphalt placed on portions of it. Curb and gutters have been constructed on the west half. The roadway cannot structurally carry the vehicle loads, is showing serious deterioration and needs to be totally reconstructed.

Comments: Additional right-of-way may be required. Cost is unknown at this time. This road was evaluated in the recently adopted 31st Street Corridor Study.

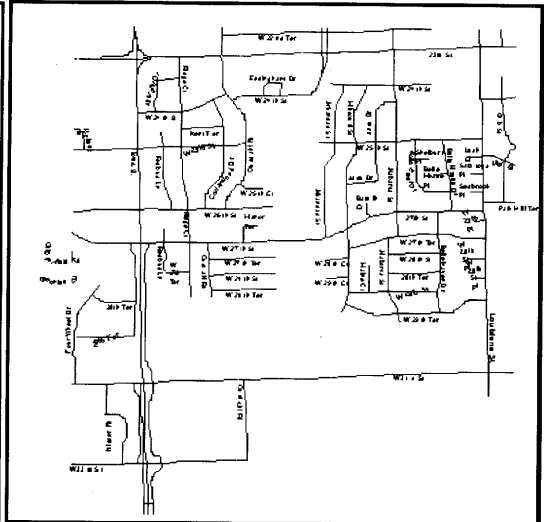

EXPENDITURE SCHEDULE (\$000,S)

PROJECT ELEMENT	TOTAL	THRU 2004	2005	2006	2007	2008	2009	2010	BEYOND 2010
PLANNING									
DESIGN	200				200				
LAND									
CONSTRUCTION	1800				1800				
EQUIPMENT									
2% FOR ARTS									
OTHER									
TOTAL	2000				2000				

FUNDING SCHEDULE (\$000,S)

SOURCE	TOTAL	THRU 2004	2005	2006	2007	2008	2009	2010	BEYOND 2010
G. O. BONDS	500				500				
SPECIAL ASSMT.									
REVENUE BONDS									
CURRENT REV.									
FEDERAL AID									
STATE AID	1500				1500				
EX. BONDS									
OTHER									
TOTAL	2000				2000				

PROJECT TITLE West 31st Street, Louisiana
Street to Haskell Avenue

DEPARTMENTAL RESPONSIBILITY: Public Works

Description: Reconstruct the existing chip and seal roadway to a four-lane arterial with median and sidewalks on both sides from Louisiana Street to Haskell Avenue.

Justification: This roadway is an old chip and seal roadway that has had 2" asphalt placed on portions of it. The roadway cannot structurally carry the vehicle loads, is showing serious deterioration and needs to be totally reconstructed.

Comments: Additional right-of-way may be required. Cost is unknown at this time. This road was evaluated in the recently adopted 31st Street Corridor Study.

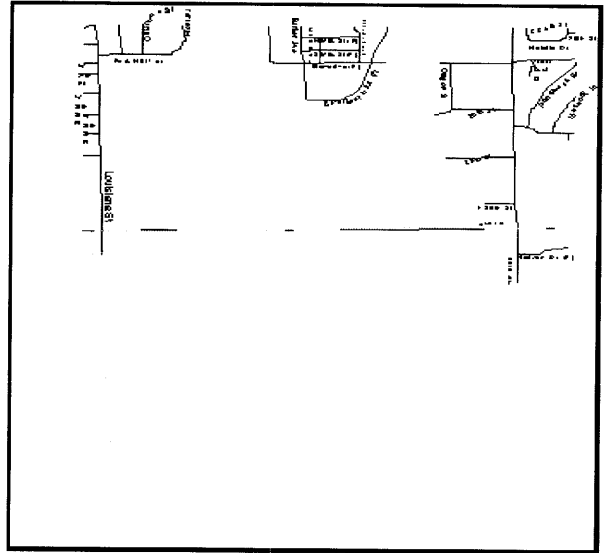
[illegible][illegible]

DEPARTMENTAL RESPONSIBILITY: Public Works

Comments: The East River Bridge Extension project is identified in the recommended street/highway improvements section of **Transportation 2020**. No money is available at this time for the East River Bridge Extension. The projected costs do not include any right-of-way acquisition for this portion of the project.

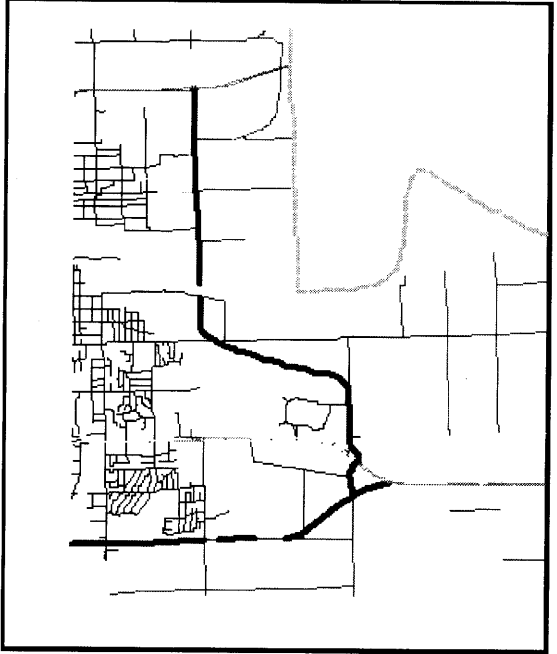
[illegible]

PROJECT TITLE: Peterson Road, Martin Park to Folks Road

DEPARTMENTAL RESPONSIBILITY: Public Works

Description: Construct approximately 1/4-mile of roadway to a minor arterial with curbs, gutters and storm sewers from Martin Park to Folks Road. Construct 10' wide recreational trail on the north side to connect with existing trail on the north side of Peterson Road.

Justification: The existing roadway is narrow and does not meet city standards. The road is designated as a secondary thoroughfare in the comprehensive plan.

Comments:

EXPENDITURE SCHEDULE (\$000,S)									
PROJECT ELEMENT	TOTAL	THRU 2004	2005	2006	2007	2008	2009	2010	BEYOND 2010
PLANNING									
DESIGN	150			150					
LAND									
CONSTRUCTION	1350			1350					
EQUIPMENT									
2% FOR ARTS									
OTHER									
TOTAL	1500			1500					

FUNDING SCHEDULE (\$000,S)									
SOURCE	TOTAL	THRU 2004	2005	2006	2007	2008	2009	2010	BEYOND 2010
G. O. BONDS	1500			1500					
SPECIAL ASSMT.									
REVENUE BONDS									
CURRENT REV.									
FEDERAL AID									
STATE AID									
EX. BONDS									
OTHER									
TOTAL	1500			1500					

PROJECT TITLE: Peterson Road, Folks Road
to George Williams Way

DEPARTMENTAL RESPONSIBILITY: Public Works

Description: Construct approximately 1 1/4-miles of roadway to a minor arterial with curbs, gutters and storm sewers from Folks Road to George Williams Way. Construct 10' wide recreational trail on the north side to connect with existing trail on the north side of Peterson Road.

Justification: There is a need to provide another east-west arterial roadway north of Highway 40 to carry the traffic from the residential developments occurring in this area. The road is designated as an arterial street in the comprehensive plan.

Comments :

[illegible][illegible]

PROJECT TITLE: West 15th Street, Naismith Drive to Iowa Street

DEPARTMENTAL RESPONSIBILITY: Public Works

Description: Construct 15th Street to a four lane roadway between Iowa Street and Burdick Drive on the KU Campus.

Justification: This improvement would improve traffic flow and efficiency to the KU Campus.

Comments: KU now has plans to make the main entrance to campus at 15th and Iowa. Additional right-of-way may be required. Cost is unknown at this time.

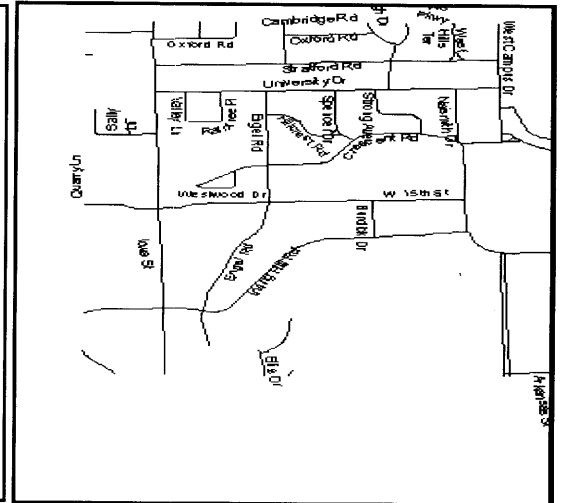

EXPENDITURE SCHEDULE (\$000,S)									
PROJECT ELEMENT	TOTAL	THRU 2004	2005	2006	2007	2008	2009	2010	BEYOND 2010
PLANNING									
DESIGN	200						200		
LAND									
CONSTRUCTION	2000						2000		
EQUIPMENT									
2* FOR ARTS									
OTHER									
TOTAL	2200						2200		

FUNDING SCHEDULE (\$000,S)									
SOURCE	TOTAL	THRU 2004	2005	2006	2007	2008	2009	2010	BEYOND 2010
G. O. BONDS	2200						2200		
SPECIAL ASSMT.									
REVENUE BONDS									
CURRENT REV.									
FEDERAL AID									
STATE AID									
EX. BONDS									
OTHER									
TOTAL	2200						2200		

PROJECT TITLE: East 31st Street, Haskell Ave.
to O'Connell Road

DEPARTMENTAL RESPONSIBILITY: Public Works

Description: Reconstruct the existing gravel roadway to a four-lane divided arterial with 10' recreational paths on one side.

Justification: This roadway has been evaluated in the recently adopted 31st Street Corridor Study.

Comments: Right-of-way acquisition is unknown at this time.

[illegible][illegible]

PROJECT TITLE: East 31st Street, O'Connell
Road to Noria Road

DEPARTMENTAL RESPONSIBILITY: Public Works

Description: Reconstruct the existing gravel roadway to a four-lane divided arterial with 10' recreational paths on one side.

Justification: This roadway has been evaluated in the recently adopted 31st Street Corridor Study.

Comments: Right-of-way acquisition is unknown at this time.

[illegible][illegible]

PROJECT TITLE: East 31st Street, Noria Rd.
to County Road 1057

DEPARTMENTAL RESPONSIBILITY: Public Works

Description: Construct 31st Street between Noria Road to County Road 1057 to a four-lane arterial with 10' wide recreational paths on one side.

Justification: This roadway has been evaluated in the recently adopted 31st Street Corridor Study.

Comments :

[illegible][illegible]

PROJECT TITLE: Kasold Drive, 6th to 15th,
Total Reconstruction

DEPARTMENTAL RESPONSIBILITY: Public Works

Description: The existing concrete roadway is severely deteriorating. An overlay will not permanently repair the roadway, so it needs to be reconstructed. Construct 10' wide recreational paths on both sides.

Justification: Kasold is a major roadway.

Comments :

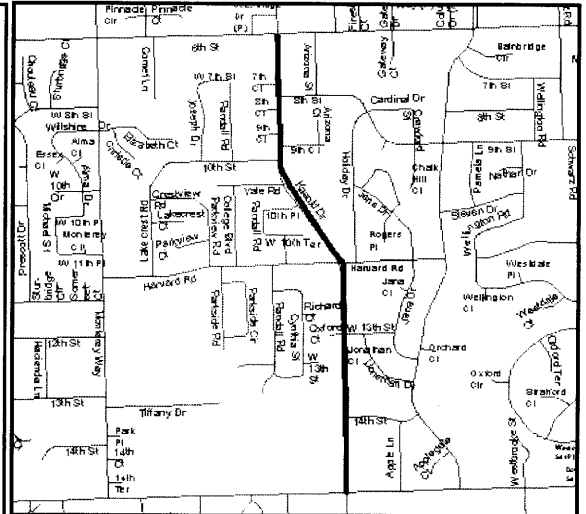
[illegible]

FUNDING SCHEDULE (\$000,S)								
SOURCE	TOTAL	THRU 2004	2005	2006	2007	2008	2009	BEYOND 2010
G. O. BONDS	2904							2904
SPECIAL ASSMT.								
REVENUE BONDS								
CURRENT REV.								
FEDERAL AID								
STATE AID								
EX. BONDS								
OTHER								
TOTAL	2904							2904

PROJECT TITLE: Kasold Drive Reconstruction W. 15th Street to Water Tower

DEPARTMENTAL RESPONSIBILITY: Public Works

Description: The existing concrete roadway is severely deteriorating. An overlay will not permanently repair the roadway, so it needs to be reconstructed. Construct 10' wide recreational paths on both sides.

Justification: Kasold is a major roadway.

Comments:

EXPENDITURE SCHEDULE (\$000,S)									
PROJECT ELEMENT	TOTAL	THRU 2004	2005	2006	2007	2008	2009	2010	BEYOND 2010
PLANNING									
DESIGN	150			150					
LAND									
CONSTRUCTION	1350			1350					
EQUIPMENT									
2% FOR ARTS									
OTHER									
TOTAL	1500			1500					

FUNDING SCHEDULE (\$000,S)									
SOURCE	TOTAL	THRU 2004	2005	2006	2007	2008	2009	2010	BEYOND 2010
G. O. BONDS	1500			1500					
SPECIAL ASSMT.									
REVENUE BONDS									
CURRENT REV.									
FEDERAL AID									
STATE AID									
EX. BONDS									
OTHER									
TOTAL	1500			1500					

PROJECT TITLE: Kasold Drive Reconstruction Water Tower to Clinton Pkwy

DEPARTMENTAL RESPONSIBILITY: Public Works

Description: The existing concrete roadway is severely deteriorating. An overlay will not permanently repair the roadway, so it needs to be reconstructed. Construct 10' wide recreational paths on both sides.

Justification: Kasold is a major roadway.

Comments:

EXPENDITURE SCHEDULE (\$000,S)									
PROJECT ELEMENT	TOTAL	THRU 2004	2005	2006	2007	2008	2009	2010	BEYOND 2010
PLANNING									
DESIGN	150		150						
LAND									
CONSTRUCTION	1350		1350						
EQUIPMENT									
2% FOR ARTS									
OTHER									
TOTAL	1500		1500						

FUNDING SCHEDULE (\$000,S)									
SOURCE	TOTAL	THRU 2004	2005	2006	2007	2008	2009	2010	BEYOND 2010
G. O. BONDS	1500		1500						
SPECIAL ASSMT.									
REVENUE BONDS									
CURRENT REV.									
FEDERAL AID									
STATE AID									
EX. BONDS									
OTHER									
TOTAL	1500		1500						

DEPARTMENTAL RESPONSIBILITY: Public Works

Comments :

FUNDING SCHEDULE (\$000,S)								
SOURCE	TOTAL	THRU 2004	2005	2006	2007	2008	2009	BEYOND 2010
G. O. BONDS	3000							3000
SPECIAL ASSMT.								
REVENUE BONDS								
CURRENT REV.								
FEDERAL AID								
STATE AID								
EX. BONDS								
OTHER								
TOTAL	3000							3000

PROJECT TITLE: E 1750 Road (Noria Road),
K-10 Highway to East 31st St

DEPARTMENTAL RESPONSIBILITY: Public Works

Description: Construct approximately 1-mile of roadway to a minor arterial with curbs, gutters and storm sewers from K-10 Highway to East 31st Street. Construct 10' wide recreational trail on one side to connect with the trail on along East 31st Street.

Justification: There will be a need to provide another north-south arterial roadway within this area of the city as it develops in the years ahead. The road is designated as an arterial street in the comprehensive plan.

Comments :

[illegible]

FUNDING SCHEDULE (\$000,S)								
SOURCE	TOTAL	THRU 2004	2005	2006	2007	2008	2009	BEYOND 2010
G. O. BONDS	3000							3000
SPECIAL ASSMT.								
REVENUE BONDS								
CURRENT REV.								
FEDERAL AID								
STATE AID								
EX. BONDS								
OTHER								
TOTAL	3000							3000

PROJECT TITLE: Various Street Improvement Projects involving Special Benefit Districts

DEPARTMENTAL RESPONSIBILITY: Public Works

Description: Construction of new streets and major renovation of existing streets in the city having a portion of the total improvement costs being the responsibility of the City.

Justification: This does not have an identified project(s). Rather, it anticipates the need for money to be available to pay for the City's share of certain street improvements.

Comments:

EXPENDITURE SCHEDULE (\$000,S)									
PROJECT ELEMENT	TOTAL	THRU 2004	2005	2006	2007	2008	2009	2010	BEYOND 2010
PLANNING									
DESIGN									
LAND									
CONSTRUCTION	1000		1000						
EQUIPMENT									
2% FOR ARTS									
OTHER									
TOTAL	1000		1000						

FUNDING SCHEDULE (\$000,S)									
SOURCE	TOTAL	THRU 2004	2005	2006	2007	2008	2009	2010	BEYOND 2010
G. O. BONDS	1000		1000						
SPECIAL ASSMT.									
REVENUE BONDS									
CURRENT REV.									
FEDERAL AID									
STATE AID									
EX. BONDS									
OTHER									
TOTAL	1000		1000						

PROJECT TITLE: Various Street Milling and Resurfacing Projects involving KLINK Funds along Urban Highways

DEPARTMENTAL RESPONSIBILITY: Public Works

Description: Mill the existing asphalt surface, replace curb and gutter sections that have deteriorated, and resurface the roadway sections along some of the urban highways passing through the city such as North 2nd Street, Iowa Street, West 23rd Street, and West 6th Street.

Justification: These urban highways require periodic maintenance and repairs more frequently than other streets because of the heavier traffic usage they receive. There is a program administered by the State Department of Transportation that allocates funds to the local community to use for a share of the cost to complete these projects.

Comments: The City has started to assess which route segments to submit to KDOT for the next four years beginning with the year 2006.

EXPENDITURE SCHEDULE (\$000,S)									
PROJECT ELEMENT	TOTAL	THRU 2004	2005	2006	2007	2008	2009	2010	BEYOND 2010
PLANNING									
DESIGN	240			60	60	60	60		
LAND									
CONSTRUCTION	2360			590	590	590	590		
EQUIPMENT									
2% FOR ARTS									
OTHER									
TOTAL	2600			650	650	650	650		

FUNDING SCHEDULE (\$000,S)									
SOURCE	TOTAL	THRU 2004	2005	2006	2007	2008	2009	2010	BEYOND 2010
G. O. BONDS	1800			450	450	450	450		
SPECIAL ASSMT.									
REVENUE BONDS									
CURRENT REV.									
FEDERAL AID									
STATE AID	800			200	200	200	200		
EX. BONDS									
OTHER									
TOTAL	2600			650	650	650	650		

PROJECT TITLE: Kasold Drive, Peterson Road to the Kansas Turnpike

DEPARTMENTAL RESPONSIBILITY: Public Works

Description: Construct approximately 3500 feet of roadway to a 4-lane arterial with curbs, gutters and storm sewers from Peterson to the Turnpike.

Justification: The existing roadway is a county road cross-section and needs to be improved to accomodate development in this area.

Comments:

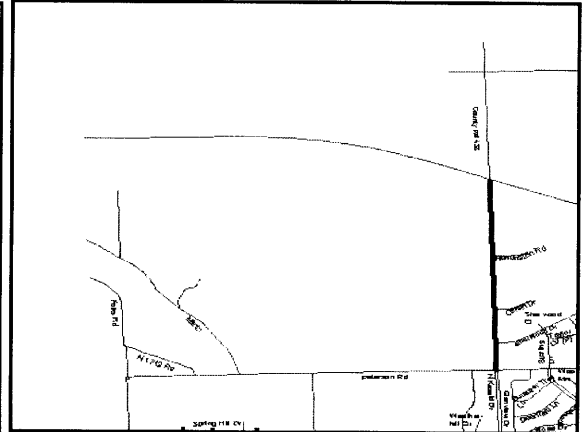

EXPENDITURE SCHEDULE (\$000,S)									
PROJECT ELEMENT	TOTAL	THRU 2004	2005	2006	2007	2008	2009	2010	BEYOND 2010
PLANNING									
DESIGN	176			176					
LAND									
CONSTRUCTION	1750			1750					
EQUIPMENT									
2% FOR ARTS									
OTHER	260			260					
TOTAL	2186			2186					

FUNDING SCHEDULE (\$000,S)									
SOURCE	TOTAL	THRU 2004	2005	2006	2007	2008	2009	2010	BEYOND 2010
G. O. BONDS	1000			1000					
SPECIAL ASSMT.	1186			1186					
REVENUE BONDS									
CURRENT REV.									
FEDERAL AID									
STATE AID									
EX. BONDS									
OTHER									
TOTAL	2186			2186					

PROJECT TITLE: Kasold Drive Bridge Replacement Over the Kansas Turnpike

DEPARTMENTAL RESPONSIBILITY: Public Works

Description: Construct a new 4-lane bridge over the Kansas Turnpike with 2' jersey barriers on each side and 6' sidewalks on each side. The overall width of the bridge structure will be 66' wide by 253' long.

Justification: The existing two-lane bridge must be replaced with a wider four-lane bridge to avoid a bottleneck in the flow of traffic funneling from a four-lane roadway south of the turnpike down to two lanes.

Comments: The project will use State, KTA and county funds to pay for the improvements.

EXPENDITURE SCHEDULE (\$000,S)									
PROJECT ELEMENT	TOTAL	THRU 2004	2005	2006	2007	2008	2009	2010	BEYOND 2010
PLANNING									
DESIGN	160		160						
LAND									
CONSTRUCTION	1440		1440						
EQUIPMENT									
2% FOR ARTS									
OTHER									
TOTAL	1600		1600						

FUNDING SCHEDULE (\$000,S)									
SOURCE	TOTAL	THRU 2004	2005	2006	2007	2008	2009	2010	BEYOND 2010
G. O. BONDS									
SPECIAL ASSMT.									
REVENUE BONDS									
CURRENT REV.									
FEDERAL AID									
STATE AID	1000		1000						
EX. BONDS									
OTHER (County)	300		300						
OTHER (KTA)	300		300						
TOTAL	1600		1600						

PROJECT TITLE: 23rd Street, Louisiana Street to Noria Road

DEPARTMENTAL RESPONSIBILITY: Planning/Public Works

Description: Implement the recommendations from the Access Management Study for this corridor.

Justification: Traffic is becoming congested and accidents are occurring.

Comments:

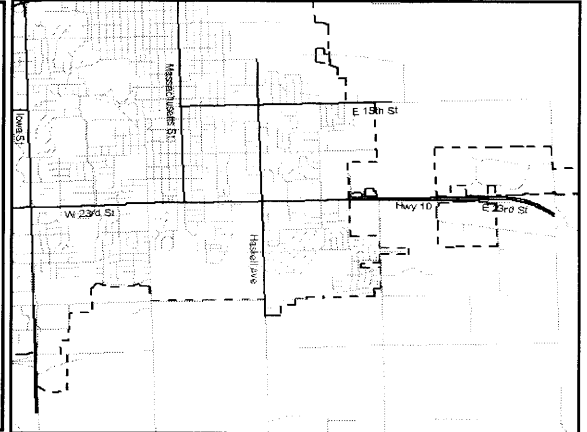

EXPENDITURE SCHEDULE (\$000,S)

PROJECT ELEMENT	TOTAL	THRU 2004	2005	2006	2007	2008	2009	2010	BEYOND 2010
PLANNING									
DESIGN	1968					1968			
LAND	500					500			
CONSTRUCTION	7955					7955			
EQUIPMENT	2520					2520			
2% FOR ARTS									
OTHER	1795					1795			
TOTAL	14738					14738			

FUNDING SCHEDULE (\$000,S)

SOURCE	TOTAL	THRU 2004	2005	2006	2007	2008	2009	2010	BEYOND 2010
G. O. BONDS	14738					14738			
SPECIAL ASSMT.									
REVENUE BONDS									
CURRENT REV.									
FEDERAL AID									
STATE AID									
EX. BONDS									
OTHER									
TOTAL	14738					14738			

PROJECT TITLE: 23rd Street, Iowa Street to Louisiana Street

DEPARTMENTAL RESPONSIBILITY: Planning/Public Works

Description: Implement the recommendations from the Access Management Study for this corridor.

Justification: Traffic is becoming congested and accidents are occurring.

Comments:

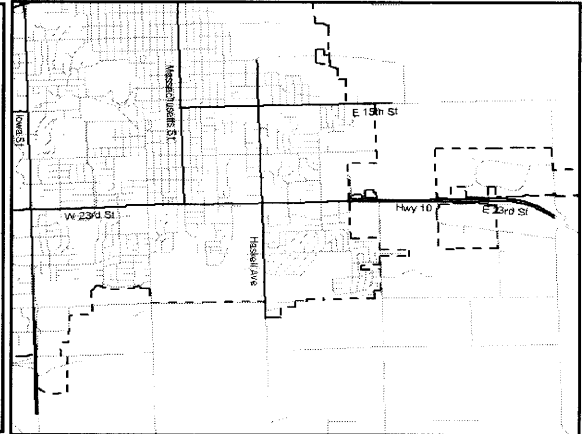

EXPENDITURE SCHEDULE (\$000,S)

PROJECT ELEMENT	TOTAL	THRU 2004	2005	2006	2007	2008	2009	2010	BEYOND 2010
PLANNING									
DESIGN	63				63				
LAND	122				122				
CONSTRUCTION	631				631				
EQUIPMENT									
2% FOR ARTS									
OTHER	120				120				
TOTAL	936				936				

FUNDING SCHEDULE (\$000,S)

SOURCE	TOTAL	THRU 2004	2005	2006	2007	2008	2009	2010	BEYOND 2010
G. O. BONDS	436				436				
SPECIAL ASSMT.									
REVENUE BONDS									
CURRENT REV.									
FEDERAL AID									
STATE AID	500				500				
EX. BONDS									
OTHER									
TOTAL	936				936				

PROJECT TITLE: George Williams Way, north
of W. 6th St. for one mile

DEPARTMENTAL RESPONSIBILITY: Public Works

Description: Construct a new roadway to serve the development north of 6th Street.

Justification: This road will be needed to serve future development.

Comments:

EXPENDITURE SCHEDULE (\$000,S)									
PROJECT ELEMENT	TOTAL	THRU 2004	2005	2006	2007	2008	2009	2010	BEYOND 2010
PLANNING									
DESIGN	264							264	
LAND									
CONSTRUCTION	2640							2640	
EQUIPMENT									
2% FOR ARTS									
OTHER									
TOTAL	2904							2904	

FUNDING SCHEDULE (\$000,S)									
SOURCE	TOTAL	THRU 2004	2005	2006	2007	2008	2009	2010	BEYOND 2010
G. O. BONDS									
SPECIAL ASSMT.	2904							2904	
REVENUE BONDS									
CURRENT REV.									
FEDERAL AID									
STATE AID									
EX. BONDS									
OTHER									
TOTAL	2904							2904	

PROJECT TITLE: North Street N. 2nd Street to N. 7th Street

DEPARTMENTAL RESPONSIBILITY: Public Works

Description: Reconstruct the existing street to a 36' (including bike lane) wide collector street with curb and gutter, underground storm sewer system and sidewalks on both sides.

Justification: This road is currently a narrow chip and seal street with roadside ditches.

Comments: The Lawrence-Douglas County Planning Commission recommended this project be included in the Capital Improvements Plan.

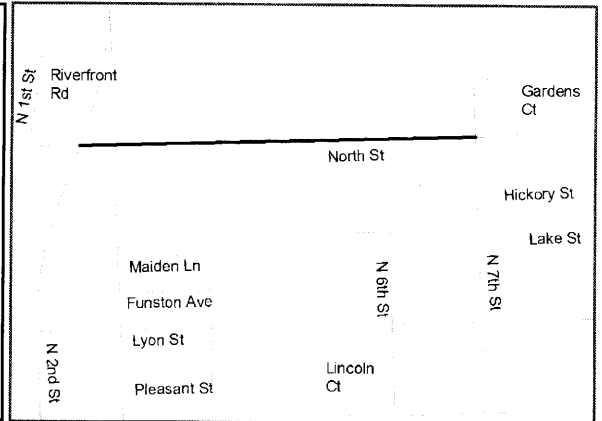

EXPENDITURE SCHEDULE (\$000,S)

PROJECT ELEMENT	TOTAL	THRU 2004	2005	2006	2007	2008	2009	2010	BEYOND 2010
PLANNING									
DESIGN	150					150			
LAND	50					50			
CONSTRUCTION	1200					1200			
EQUIPMENT									
2% FOR ARTS									
OTHER									
TOTAL	1400					1400			

FUNDING SCHEDULE (\$000,S)

SOURCE	TOTAL	THRU 2004	2005	2006	2007	2008	2009	2010	BEYOND 2010
G. O. BONDS	280					280			
SPECIAL ASSMT.									
REVENUE BONDS									
CURRENT REV.									
FEDERAL AID									
STATE AID	1120					1120			
EX. BONDS									
OTHER									
TOTAL	1400					1400			

PROJECT TITLE: Mississippi Street, 9th Street to 11th Street

DEPARTMENTAL RESPONSIBILITY: Public Works

Description: Widen Mississippi, including 9th and Mississippi to handle additional traffic.

Justification: Due to the construction of the KU parking garage, additional traffic will be generated, dictating future improvements to Mississippi.

Comments:

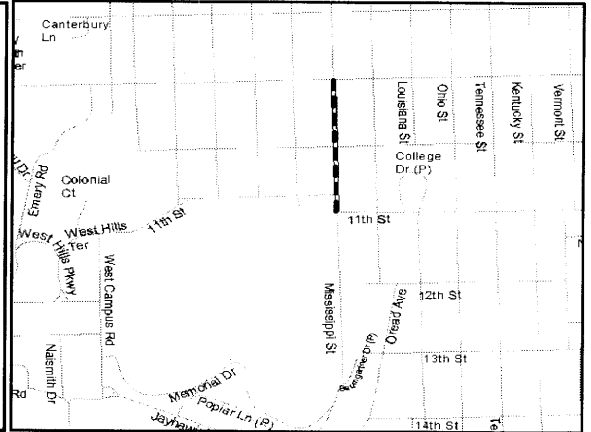

EXPENDITURE SCHEDULE (\$000,S)

PROJECT ELEMENT	TOTAL	THRU 2004	2005	2006	2007	2008	2009	2010	BEYOND 2010
PLANNING									
DESIGN	60				60				
LAND									
CONSTRUCTION	600				600				
EQUIPMENT									
2% FOR ARTS									
OTHER									
TOTAL	660				660				

FUNDING SCHEDULE (\$000,S)

SOURCE	TOTAL	THRU 2004	2005	2006	2007	2008	2009	2010	BEYOND 2010
G. O. BONDS	660				660				
SPECIAL ASSMT.									
REVENUE BONDS									
CURRENT REV.									
FEDERAL AID									
STATE AID									
EX. BONDS									
OTHER									
TOTAL	660				660				

PROJECT TITLE: N 1500 Road, George Williams
Way to the Frontage Road
along the SLT

DEPARTMENTAL RESPONSIBILITY: Public Works

Description: Reconstruct the existing gravel road to a two lane city standard collector street.

Justification: This road will serve the existing neighborhood (Lake Estates) on the east side of the South Lawrence Trafficway (K-10 Highway). It will provide access to W. 15th Street at George Williams Way.

Comments :

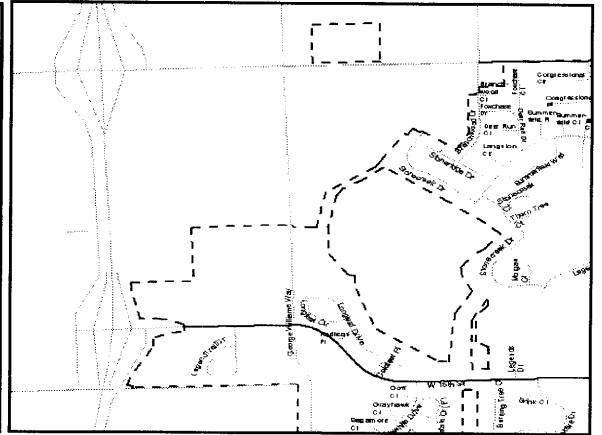
[illegible][illegible]

PROJECT TITLE: Stone Curb Restoration 1000-1100 Block Tennessee St

DEPARTMENTAL RESPONSIBILITY: Public Works

Description: Remove the existing stone curbs on the west side of the 1000 and 1100 blocks of Tennessee Street and restore the useable pieces on the west side of the 1000 block. Replace the stone curbs with concrete curbs in the 1100 block to match the work done previously on the east side of this block. Reset existing stairs to match the new height of reset curbs as needed.

Justification: Most of the existing stone curbs in these two blocks are buried into the ground and the street has been overlayed to the point there is no defineable curb height remaining. Careful removal of the existing stone curbs will allow many of them to be reused again. Concentrating on restoring the stone curbs on the west side of the 1000 block is important to the local historic district designation given to this block.

Comments: This project has been submitted by Charles Goff III, Coordinator for Oread Neighborhood Association.

EXPENDITURE SCHEDULE (\$000,S)									
PROJECT ELEMENT	TOTAL	THRU 2004	2005	2006	2007	2008	2009	2010	BEYOND 2010
PLANNING									
DESIGN									
LAND									
CONSTRUCTION	150						150		
EQUIPMENT									
2% FOR ARTS									
OTHER									
TOTAL	150						150		

FUNDING SCHEDULE (\$000,S)									
SOURCE	TOTAL	THRU 2004	2005	2006	2007	2008	2009	2010	BEYOND 2010
G. O. BONDS	150						150		
SPECIAL ASSMT.									
REVENUE BONDS									
CURRENT REV.									
FEDERAL AID									
STATE AID									
EX. BONDS									
OTHER									
TOTAL	150						150		

PROJECT TITLE: Brick Street Restoration New York & Rhode Island St

DEPARTMENTAL RESPONSIBILITY: Public Works

Description: Restore the existing brick streets in the 800 block of New York Street and the intersection of East 10th Street and Rhode Island Street.

Justification: The condition of the street is very uneven and there are still patches of asphalt on top of the brick which creates excessive debris from weathering.

The East Lawrence Neighborhood Plan emphasizes the fact that brick streets are one of the neighborhood's historic resources. This being the case, it is important that they be kept in good condition.

Comments: This project coincides with the Capital Improvement Project planned for ????? of Brick Street Restoration in the 1200-1500 blocks of Pennsylvania St and the 1300 block of Rhode Island St.

EXPENDITURE SCHEDULE (\$000,S)									
PROJECT ELEMENT	TOTAL	THRU 2004	2005	2006	2007	2008	2009	2010	BEYOND 2010
PLANNING	30			30					
DESIGN									
LAND									
CONSTRUCTION	720			720					
EQUIPMENT									
2% FOR ARTS									
OTHER									
TOTAL	750			750					

FUNDING SCHEDULE (\$000,S)									
SOURCE	TOTAL	THRU 2004	2005	2006	2007	2008	2009	2010	BEYOND 2010
G. O. BONDS	750			750					
SPECIAL ASSMT.									
REVENUE BONDS									
CURRENT REV.									
FEDERAL AID									
STATE AID									
EX. BONDS									
OTHER									
TOTAL	750			750					

PROJECT TITLE: Brick Street Restoration Pennsylvania & Rhode Island St

DEPARTMENTAL RESPONSIBILITY: Public Works

Description: Remove the asphalt and repair brick from the predominantly brick streets on Pennsylvania Street between 12th and 15th, and on the 1300 block of Rhode Island Street.

Justification: The patches of asphalt on top of the brick creates excessive debris from weathering.

The East Lawrence Neighborhood Plan emphasizes the fact that brick streets are one of the neighborhood's historic resources. This being the case, it is important that they be kept in good condition.

Comments: This project coincides with the Capital Improvement Project planned for 2006 of Brick Street Restoration of the 800 block of New York St and East 10th & Rhode Island St intersection.

EXPENDITURE SCHEDULE (\$000,S)									
PROJECT ELEMENT	TOTAL	THRU 2004	2005	2006	2007	2008	2009	2010	BEYOND 2010
PLANNING									
DESIGN	120						30	30	60
LAND									
CONSTRUCTION	1280						320	320	640
EQUIPMENT									
2% FOR ARTS									
OTHER									
TOTAL	1400						350	350	700

FUNDING SCHEDULE (\$000,S)									
SOURCE	TOTAL	THRU 2004	2005	2006	2007	2008	2009	2010	BEYOND 2010
G. O. BONDS	1400						350	350	700
SPECIAL ASSMT.									
REVENUE BONDS									
CURRENT REV.									
FEDERAL AID									
STATE AID									
EX. BONDS									
OTHER									
TOTAL	1400						350	350	700

PUBLIC WORKS DEPARTMENT PROJECTS

(Intersection Improvements)

PROJECT TITLE: 19th St. & Louisiana St.

DEPARTMENTAL RESPONSIBILITY: Public Works

Description:

Construction of a roundabout replacing the existing traffic signal.

Justification:

Recommended in the Louisiana Street Traffic Calming Study, April 2000.

Comments:

This intersection continues to experience congestion and accidents even with a traffic signal in place.

EXPENDITURE SCHEDULE (\$000, S)									
PROJECT ELEMENT	TOTAL	THRU 2004	2005	2006	2007	2008	2009	2010	BEYOND 2010
PLANNING									
DESIGN	50	50							
LAND	150		150						
CONSTRUCTION	300		300						
EQUIPMENT									
2% FOR ARTS									
OTHER									
TOTAL	500	50	450						

FUNDING SCHEDULE (\$000, S)									
SOURCE	TOTAL	THRU 2004	2005	2006	2007	2008	2009	2010	BEYOND 2010
G. O. BONDS	500	50	450						
SPECIAL ASSMT.									
REVENUE BONDS									
CURRENT REV.									
FEDERAL AID									
STATE AID									
EX. BONDS									
OTHER									
TOTAL	500	50	450						

PROJECT TITLE: Clinton Parkway & Kasold Drive

DEPARTMENTAL RESPONSIBILITY: Public Works

Description: Lengthen the southbound left turn lane or provide dual lanes. Extend the existing sidewalk along the west side of Kasold Drive from the north to the Clinton Parkway Trail.

Justification: The southbound left turn lane volume exceeds the existing lane capacity.

Comments:

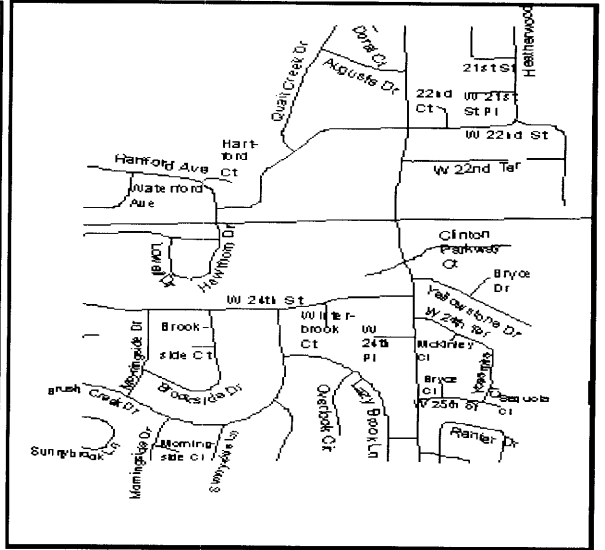

EXPENDITURE SCHEDULE (\$000,S)									
PROJECT ELEMENT	TOTAL	THRU 2004	2005	2006	2007	2008	2009	2010	BEYOND 2010
PLANNING									
DESIGN	50						50		
LAND									
CONSTRUCTION	500						500		
EQUIPMENT									
2% FOR ARTS									
OTHER									
TOTAL	550						550		

FUNDING SCHEDULE (\$000,S)									
SOURCE	TOTAL	THRU 2004	2005	2006	2007	2008	2009	2010	BEYOND 2010
G. O. BONDS	550						550		
SPECIAL ASSMT.									
REVENUE BONDS									
CURRENT REV.									
FEDERAL AID									
STATE AID									
EX. BONDS									
OTHER									
TOTAL	550						550		

PROJECT TITLE: 15th & Haskell Avenue Roundabout

DEPARTMENTAL RESPONSIBILITY: Public Works

Description: Construct a single-lane, large diameter roundabout with center island of 50' diameter, 20' wide road lane, a 90' outer curb diameter and 105' diameter outside of sidewalk to improve safety for pedestrians and motorists.

Justification: The intersection has been experiencing greater congestion because of increasing commercial truck traffic and non-local commuter cut-through traffic.

Comments: This project was submitted by the Brook Creek Nieghborhood Association. Land may need to be purchased to assure there is sufficient right-of-way for these improvements.

EXPENDITURE SCHEDULE (\$000,S)

PROJECT ELEMENT	TOTAL	THRU 2004	2005	2006	2007	2008	2009	2010	BEYOND 2010
PLANNING									
DESIGN	35					35			
LAND	25					25			
CONSTRUCTION	290					290			
EQUIPMENT									
2% FOR ARTS									
OTHER									
TOTAL	350					350			

FUNDING SCHEDULE (\$000,S)

SOURCE	TOTAL	THRU 2004	2005	2006	2007	2008	2009	2010	BEYOND 2010
G. O. BONDS	350					350			
SPECIAL ASSMT.									
REVENUE BONDS									
CURRENT REV.									
FEDERAL AID									
STATE AID									
EX. BONDS									
OTHER									
TOTAL	350					350			

PROJECT TITLE: W. 23rd Street & Iowa Street Intersection Improvement

DEPARTMENTAL RESPONSIBILITY: Public Works

Description: Construct geometric and traffic signal improvements at the intersection, including construction of double left turn lanes on all legs of the intersection per traffic study completed in 1999.

Justification: There are capacity constraints at this intersection which will be improved.

Comments: Additional right-of-way is required. Cost is unknown at this time.

EXPENDITURE SCHEDULE (\$000,S)									
PROJECT ELEMENT	TOTAL	THRU 2004	2005	2006	2007	2008	2009	2010	BEYOND 2010
PLANNING									
DESIGN	160					160			
LAND	200					200			
CONSTRUCTION	1600					1600			
EQUIPMENT									
2% FOR ARTS									
OTHER (Inspection)	240					240			
TOTAL	2200					2200			

FUNDING SCHEDULE (\$000,S)									
SOURCE	TOTAL	THRU 2004	2005	2006	2007	2008	2009	2010	BEYOND 2010
G. O. BONDS	728					728			
SPECIAL ASSMT.									
REVENUE BONDS									
CURRENT REV.									
FEDERAL AID									
STATE AID	1472					1472			
EX. BONDS									
OTHER									
TOTAL	2200					2200			

PROJECT TITLE: 15th Street Traffic Calming Devices

DEPARTMENTAL RESPONSIBILITY: Public Works

Description: Construct a single-lane, mini-roundabout of 84' diameter (outer extent of sidewalk) located at the east city limits. Construct two "two-way slow points with median" lane deflectors; one just west of Elmwood Street, and one just east of Harper Street.

Justification: To deter the excess speeds and volumes of cut-through commuter traffic and increasingly heavier commercial traffic through the residential neighborhood.

Comments: This project was submitted by the Brook Creek Neighborhood Association. Land may need to be purchased to assure there is sufficient right-of-way for the mini-roundabout project. City Traffic Engineer estimates cost of the mini-roundabout without land acquisition to be approximately \$110,000. One two-way slow point was constructed at Brook Street in 2003.

EXPENDITURE SCHEDULE (\$000,S)									
PROJECT ELEMENT	TOTAL	THRU 2004	2005	2006	2007	2008	2009	2010	BEYOND 2010
PLANNING									
DESIGN	25				10	15			
LAND									
CONSTRUCTION	260	10			100	150			
EQUIPMENT									
2% FOR ARTS									
OTHER									
TOTAL	285				110	165			

FUNDING SCHEDULE (\$000,S)									
SOURCE	TOTAL	THRU 2004	2005	2006	2007	2008	2009	2010	BEYOND 2010
G. O. BONDS	275				110	165			
SPECIAL ASSMT.									
REVENUE BONDS									
CURRENT REV.									
FEDERAL AID									
STATE AID									
EX. BONDS									
OTHER	10	10							
TOTAL	285	10			110	165			

PROJECT TITLE: Louisiana Street
Roundabout at Checkers/Malls
Shopping Center Driveways

DEPARTMENTAL RESPONSIBILITY: Public Works

Description: Construct a roundabout to ease traffic tensions at a spot where driveways into and out of Checkers grocery store (on the east) and the Malls Shopping Center (on the west) parking lots join Louisiana Street.

Justification: The congestion and confusing traffic pattern around these intersections have contributed to accidents and a generally dangerous situation. The roundabout has been proposed as a means of improving traffic safety and flow along this section of Louisiana.

Comments: This project is a recommendation of the Louisiana Street traffic calming study. Parkhill Neighborhood Association voted to strongly support the traffic roundabout be included in the Capital Improvements Plan. Land may need to be purchased to assure there is sufficient right-of-way for the roundabout.

[illegible][illegible]

PROJECT TITLE: Louisiana & W. 27th Terrace Roundabout

DEPARTMENTAL RESPONSIBILITY: Public Works

Description: Construct a roundabout to ease traffic tensions at a spot where driveways into and out of South Junior High School (on the east) and the Indian Hills Neighborhood (on the west) join Louisiana Street.

Justification: The congestion and confusing traffic pattern around this intersection has contributed to accidents and a generally dangerous situation. The roundabout has been proposed as a means of improving traffic safety and flow along this section of Louisiana.

Comments: This project is a recommendation of the Louisiana Street traffic calming study and was approved by the City Commission. Land may need to be purchased to assure there is sufficient right-of-way for the roundabout.

EXPENDITURE SCHEDULE (\$000,S)									
PROJECT ELEMENT	TOTAL	THRU 2004	2005	2006	2007	2008	2009	2010	BEYOND 2010
PLANNING									
DESIGN	35		35						
LAND									
CONSTRUCTION	315		315						
EQUIPMENT									
2% FOR ARTS									
OTHER									
TOTAL	350		350						

FUNDING SCHEDULE (\$000,S)									
SOURCE	TOTAL	THRU 2004	2005	2006	2007	2008	2009	2010	BEYOND 2010
G. O. BONDS	350		350						
SPECIAL ASSMT.									
REVENUE BONDS									
CURRENT REV.									
FEDERAL AID									
STATE AID									
EX. BONDS									
OTHER									
TOTAL	350		350						

PROJECT TITLE: Traffic Calming

DEPARTMENTAL RESPONSIBILITY: Public Works

Description:

Construction of various traffic calming devices throughout the city on local streets and collector streets.

Justification:

Based upon requests from neighborhood groups and recommended for approval by the Traffic Safety Commission.

Comments:

EXPENDITURE SCHEDULE (\$000,S)									
PROJECT ELEMENT	TOTAL	THRU 2004	2005	2006	2007	2008	2009	2010	BEYOND 2010
PLANNING									
DESIGN	150		25	25	25	25	25	25	
LAND									
CONSTRUCTION	450		75	75	75	75	75	75	
EQUIPMENT									
2% FOR ARTS									
OTHER									
TOTAL	600		100	100	100	100	100	100	

FUNDING SCHEDULE (\$000,S)									
SOURCE	TOTAL	THRU 2004	2005	2006	2007	2008	2009	2010	BEYOND 2010
G. O. BONDS	600		100	100	100	100	100	100	
SPECIAL ASSMT.									
REVENUE BONDS									
CURRENT REV.									
FEDERAL AID									
STATE AID									
EX. BONDS									
OTHER									
TOTAL	600		100	100	100	100	100	100	

PUBLIC WORKS DEPARTMENT PROJECTS

(Traffic Signals)

PROJECT TITLE: 6th Street & Michigan Street Intersection Improvement

DEPARTMENTAL RESPONSIBILITY: Public Works

Description: Upgrade the existing traffic signals and construct geometric improvements on Michigan.

Justification: The traffic volume at this intersection warrants left-turn lanes on Michigan Street.

Comments: Additional right-of-way may be required. Cost is unknown at this time. Project shall be designed with future bike lanes along Michigan Street.

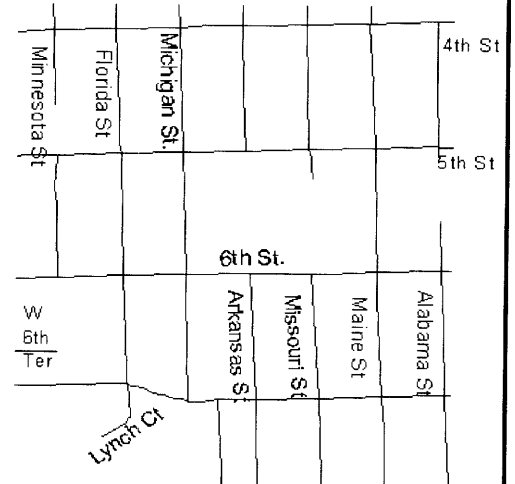

EXPENDITURE SCHEDULE (\$000,S)

PROJECT ELEMENT	TOTAL	THRU 2004	2005	2006	2007	2008	2009	2010	BEYOND 2010
PLANNING									
DESIGN	100			100					
LAND	100			100					
CONSTRUCTION	500			500					
EQUIPMENT									
2% FOR ARTS									
OTHER									
TOTAL	700			700					

FUNDING SCHEDULE (\$000,S)

SOURCE	TOTAL	THRU 2004	2005	2006	2007	2008	2009	2010	BEYOND 2010
G. O. BONDS	700			700					
SPECIAL ASSMT.									
REVENUE BONDS									
CURRENT REV.									
FEDERAL AID									
STATE AID									
EX. BONDS									
OTHER									
TOTAL	700			700					

PROJECT TITLE: 25th Street & Iowa Street Traffic Signal

DEPARTMENTAL RESPONSIBILITY: Public Works

Description: Upgrade the existing traffic signal and construct geometric improvements on West 25th.

Justification: The traffic volume at this intersection warrants left-turn lanes on West 25th.

Comments: Additional right-of-way may be required. Cost is unknown at this time. Project shall incorporate pedestrian and bicycle traffic crossing Iowa Street. This light is a proposed bike route crossing.

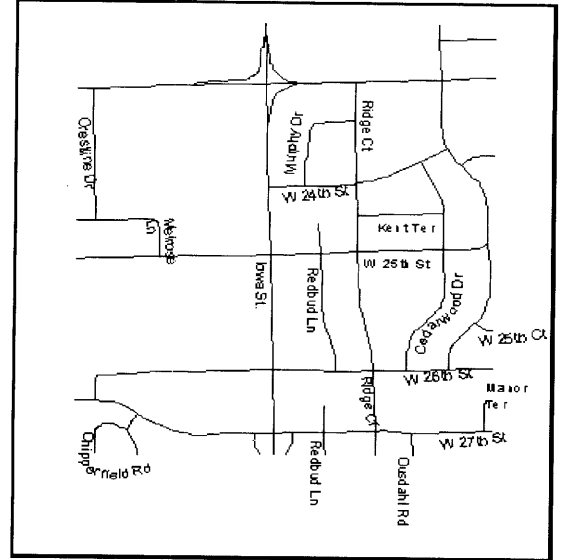

EXPENDITURE SCHEDULE (\$000,S)									
PROJECT ELEMENT	TOTAL	THRU 2004	2005	2006	2007	2008	2009	2010	BEYOND 2010
PLANNING									
DESIGN	100				100				
LAND	100				100				
CONSTRUCTION	500				500				
EQUIPMENT									
2% FOR ARTS									
OTHER									
TOTAL	700				700				

FUNDING SCHEDULE (\$000,S)									
SOURCE	TOTAL	THRU 2004	2005	2006	2007	2008	2009	2010	BEYOND 2010
G. O. BONDS	700				700				
SPECIAL ASSMT.									
REVENUE BONDS									
CURRENT REV.									
FEDERAL AID									
STATE AID									
EX. BONDS									
OTHER									
TOTAL	700				700				

PROJECT TITLE: Harvard Road & Kasold Drive
Intersection Improvement

DEPARTMENTAL RESPONSIBILITY: Public Works

Description: Construction of a traffic signal or roundabout at the intersection of Harvard Road and Kasold Drive.

Justification: This intersection meets the warrants for a traffic signal as prescribed by the **Manual on Uniform Traffic Control Devices**.

Comments: Some geometric improvements will also be needed at this intersection. Additional right-of-way may be required. Cost is unknown at this time.

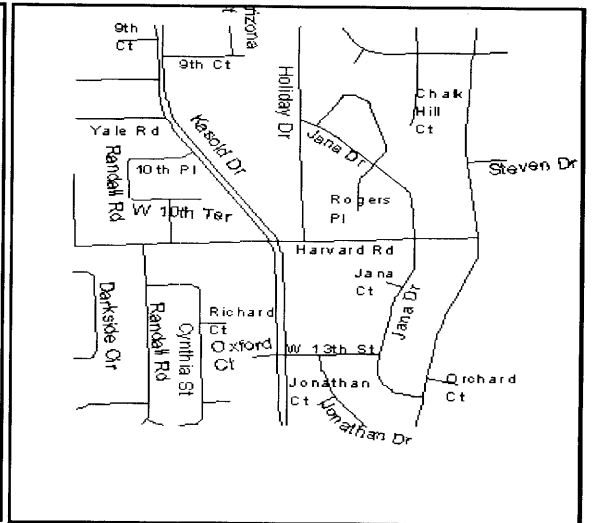
[illegible][illegible]

PROJECT TITLE: McDonald Dr & Rockledge Rd
Intersection Improvement

DEPARTMENTAL RESPONSIBILITY: Public Works

Description: Construction of a traffic signal or roundabout at the intersection of McDonald Drive and Rockledge Road.

Justification: The intersection meets the warrants for a traffic signal as prescribed by the **Manual on Uniform Traffic Control Devices**.

Comments: Geometric improvements will also be required. Additional right-of-way may be required. Cost is unknown at this time.

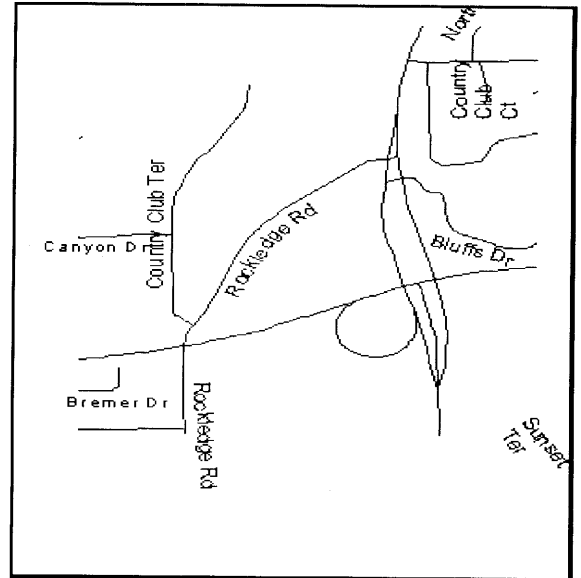

EXPENDITURE SCHEDULE (\$000,S)								
PROJECT ELEMENT	TOTAL	THRU 2004	2005	2006	2007	2008	2009	BEYOND 2010
PLANNING								
DESIGN	100							100
LAND	100							100
CONSTRUCTION	600							600
EQUIPMENT								
2% FOR ARTS								
OTHER								
TOTAL	800							800

FUNDING SCHEDULE (\$000,S)								
SOURCE	TOTAL	THRU 2004	2005	2006	2007	2008	2009	BEYOND 2010
G. O. BONDS	800							800
SPECIAL ASSMT.								
REVENUE BONDS								
CURRENT REV.								
FEDERAL AID								
STATE AID								
EX. BONDS								
OTHER								
TOTAL	800							800

PROJECT TITLE: 15th Street & Wakarusa Drive Intersection Improvement

DEPARTMENTAL RESPONSIBILITY: Public Works

Description: Construction of a traffic signal at the intersection of West 15th Street and Wakarusa Drive.

Justification: This intersection meets the warrants for a traffic signal as prescribed by the **Manual on Uniform Traffic Control Devices**.

Comments: Some geometric improvements may also be required.

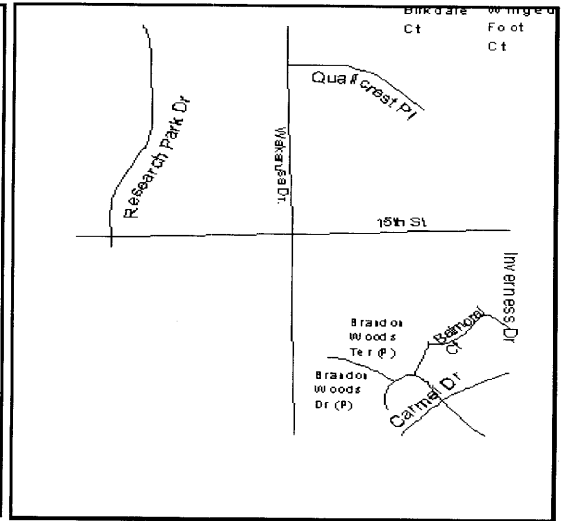

EXPENDITURE SCHEDULE (\$000, S)									
PROJECT ELEMENT	TOTAL	THRU 2004	2005	2006	2007	2008	2009	2010	BEYOND 2010
PLANNING									
DESIGN	40		40						
LAND	50		50						
CONSTRUCTION	150		150						
EQUIPMENT									
2% FOR ARTS									
OTHER									
TOTAL	240		240						

FUNDING SCHEDULE (\$000, S)									
SOURCE	TOTAL	THRU 2004	2005	2006	2007	2008	2009	2010	BEYOND 2010
G. O. BONDS	240		240						
SPECIAL ASSMT.									
REVENUE BONDS									
CURRENT REV.									
FEDERAL AID									
STATE AID									
EX. BONDS									
OTHER									
TOTAL	240		240						

PROJECT TITLE: 11th St and Connecticut St
Intersection Improvement

DEPARTMENTAL RESPONSIBILITY: Public Works

Description: Construction of a traffic signal or roundabout at the intersection of East 11th Street and Connecticut Street.

Justification: This intersection meets the warrants for a traffic signal as prescribed by the **Manual on Uniform Traffic Control Devices**.

Comments: Geometric improvements will also be required. Additional right-of-way may be required. Cost is unknown at this time. This intersection is an ideal location for benefits of a roundabout due to two proposed bike lanes.

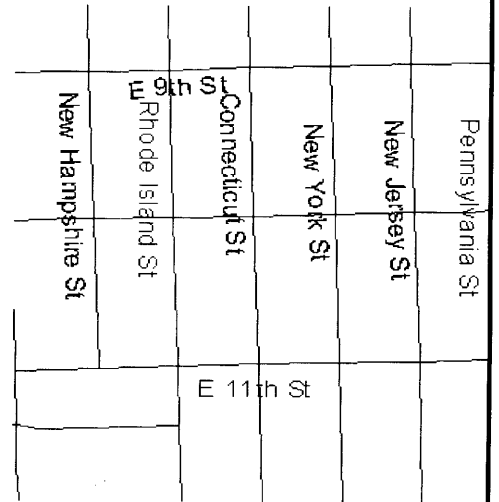
[illegible][illegible]

DEPARTMENTAL RESPONSIBILITY: Public Works

Comments: Geometric improvements will also be required. Additional right-of-way may be required. Cost is unknown at this time. Project shall be designed to accommodate pedestrian and bicycle crossing and future recreational paths.

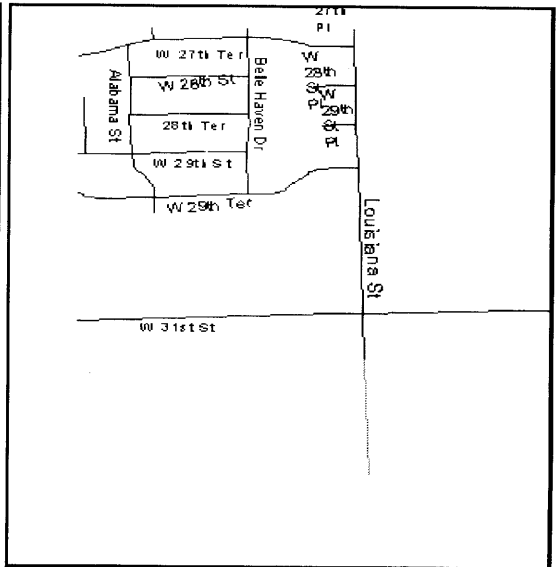
[illegible][illegible]

[illegible]

PROJECT TITLE: Inverness Drive/Legends Drive and Wakarusa Drive Intersection Improvement

DEPARTMENTAL RESPONSIBILITY: Public Works

Description: Construction of a traffic signal or roundabout at the intersection of Legends Drive/Inverness Drive and Wakarusa Drive.

Justification: This intersection meets the warrants for a traffic signal as prescribed by the **Manual on Uniform Traffic Control Devices**.

Comments: Some geometric improvements will also be required. Additional right-of-way may be needed. Cost is unknown. Project shall be designed to accommodate pedestrian and bicycle crossings.

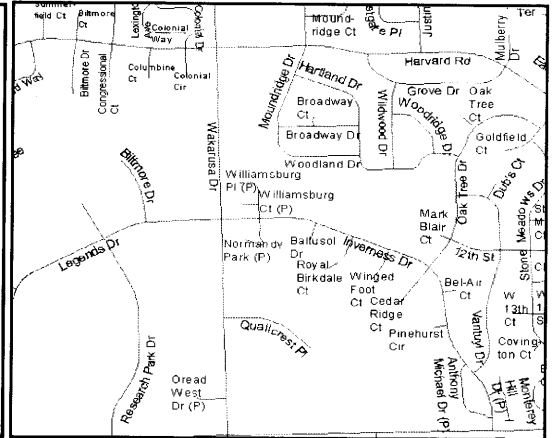

EXPENDITURE SCHEDULE (\$000,S)

PROJECT ELEMENT	TOTAL	THRU 2004	2005	2006	2007	2008	2009	2009	BEYOND 2010
PLANNING									
DESIGN	50		50						
LAND	100		100						
CONSTRUCTION	400		400						
EQUIPMENT									
2% FOR ARTS									
OTHER									
TOTAL	550		550						

FUNDING SCHEDULE (\$000,S)

SOURCE	TOTAL	THRU 2004	2005	2006	2007	2008	2009	2009	BEYOND 2010
G. O. BONDS	550		550						
SPECIAL ASSMT.									
REVENUE BONDS									
CURRENT REV.									
FEDERAL AID									
STATE AID									
EX. BONDS									
OTHER									
TOTAL	550		550						

PROJECT TITLE: Traffic Signal System - 6th Street

DEPARTMENTAL RESPONSIBILITY: Public Works

Description:

Installation of fiber optic cable, modems, and central control hardware/software to develop a closed-loop traffic signal system to monitor and optimize traffic flow along 6th Street between Massachusetts Street and Iowa Street.

Justification:

Optimization of traffic flow during multiple times of the day, seasons of the year, and during special events.

Comments:

EXPENDITURE SCHEDULE (\$000,S)									
PROJECT ELEMENT	TOTAL	THRU 2004	2005	2006	2007	2008	2009	2009	BEYOND 2010
PLANNING									
DESIGN	40			40					
LAND									
CONSTRUCTION	325			325					
EQUIPMENT									
2% FOR ARTS									
OTHER									
TOTAL	365			365					

FUNDING SCHEDULE (\$000,S)									
SOURCE	TOTAL	THRU 2004	2005	2006	2007	2008	2009	2009	BEYOND 2010
G. O. BONDS	365			365					
SPECIAL ASSMT.									
REVENUE BONDS									
CURRENT REV.									
FEDERAL AID									
STATE AID									
EX. BONDS									
OTHER									
TOTAL	365			365					

PROJECT TITLE: Traffic Signal System Coordination - Iowa Street

DEPARTMENTAL RESPONSIBILITY: Public Works

Description:

Installation of fiber optic cable, modems, and central control hardware/software to develop a closed-loop traffic signal system to monitor and optimize traffic flow along Iowa Street between 6th Street and 23rd Street.

Justification:

Optimization of traffic flow during multiple times of the day, seasons of the year, and during special events.

Comments:

EXPENDITURE SCHEDULE (\$000, S)									
PROJECT ELEMENT	TOTAL	THRU 2004	2005	2006	2007	2008	2009	2009	BEYOND 2010
PLANNING									
DESIGN	35				35				
LAND									
CONSTRUCTION	280				280				
EQUIPMENT									
2% FOR ARTS									
OTHER									
TOTAL	315				315				

FUNDING SCHEDULE (\$000, S)									
SOURCE	TOTAL	THRU 2004	2005	2006	2007	2008	2009	2009	BEYOND 2010
G. O. BONDS	315				315				
SPECIAL ASSMT.									
REVENUE BONDS									
CURRENT REV.									
FEDERAL AID									
STATE AID									
EX. BONDS									
OTHER									
TOTAL	315				315				

PROJECT TITLE: Traffic Signal System Coordination - 23rd Street

DEPARTMENTAL RESPONSIBILITY: Public Works

Description:

Installation of fiber optic cable, modems, and central control hardware/software to develop a closed-loop traffic signal system to monitor and optimize traffic flow along 23rd Street between Iowa Street and Harper Street.

Justification:

Optimization of traffic flow during multiple times of the day, seasons of the year, and during special events.

Comments:

EXPENDITURE SCHEDULE (\$000,S)									
PROJECT ELEMENT	TOTAL	THRU 2004	2005	2006	2007	2008	2009	2009	BEYOND 2010
PLANNING									
DESIGN	50					50			
LAND									
CONSTRUCTION	350					350			
EQUIPMENT									
2% FOR ARTS									
OTHER									
TOTAL	400					400			

FUNDING SCHEDULE (\$000,S)									
SOURCE	TOTAL	THRU 2004	2005	2006	2007	2008	2009	2009	BEYOND 2010
G. O. BONDS	400					400			
SPECIAL ASSMT.									
REVENUE BONDS									
CURRENT REV.									
FEDERAL AID									
STATE AID									
EX. BONDS									
OTHER									
TOTAL	400					400			

PUBLIC WORKS DEPARTMENT PROJECTS

(Storm Drainage System Improvements)

PROJECT TITLE: 20th Street and Naismith Drive to 17th Street and Alabama Storm Drainage Improvements

DEPARTMENTAL RESPONSIBILITY: Public Works

Description: This project would improve the existing storm sewer system in this area as recommended in the Stormwater Management Master Plan, 1996.

Justification: This is a critical project where recurring residential or commercial structure flooding is the direct result of the inadequacy of the existing storm drainage system.

Comments: Phase I, Priority Number 7 project in Stormwater Management Master Plan, 1996. This project would be financed with current revenues collected from the stormwater utility fee.

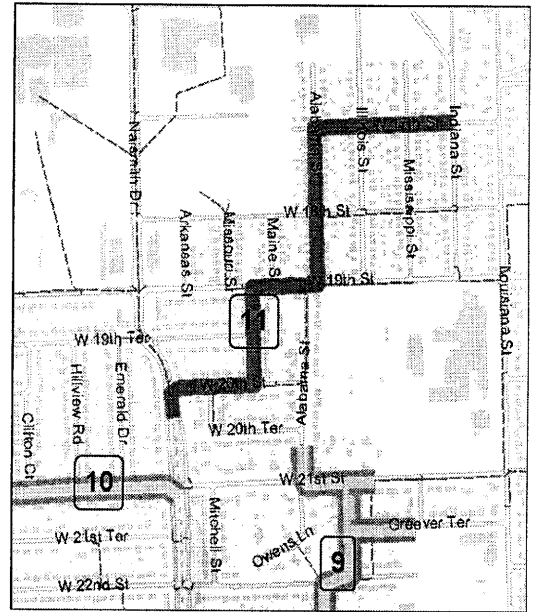

EXPENDITURE SCHEDULE (\$000,S)									
PROJECT ELEMENT	TOTAL	THRU 2004	2005	2006	2007	2008	2009	2010	BEYOND 2010
PLANNING									
DESIGN	416		416						
LAND	100		100						
CONSTRUCTION	4060			4060					
EQUIPMENT									
2% FOR ARTS									
OTHER									
TOTAL	4576		516	4060					

FUNDING SCHEDULE (\$000,S)									
SOURCE	TOTAL	THRU 2004	2005	2006	2007	2008	2009	2010	BEYOND 2010
G. O. BONDS	4060			4060					
SPECIAL ASSMT.									
REVENUE BONDS									
CURRENT REV.	516		516						
FEDERAL AID									
STATE AID									
EX. BONDS									
OTHER									
TOTAL	4576	0	516	4060	0	0	0	0	

19th to Brook Storm Drainage Improvements

DEPARTMENTAL RESPONSIBILITY: Public Works

Description: This project would improve the existing storm sewer system in this area as recommended in the Stormwater Management Master Plan, 1996.

Justification: This is a critical project where recurring residential or commercial structure flooding is the direct result of the inadequacy of the existing storm drainage system.

Comments: Phase I, Priority Number 9 project in Stormwater Management Master Plan, 1996. This project would be financed with current revenues collected from the stormwater utility fee. Projected construction year is 2011.

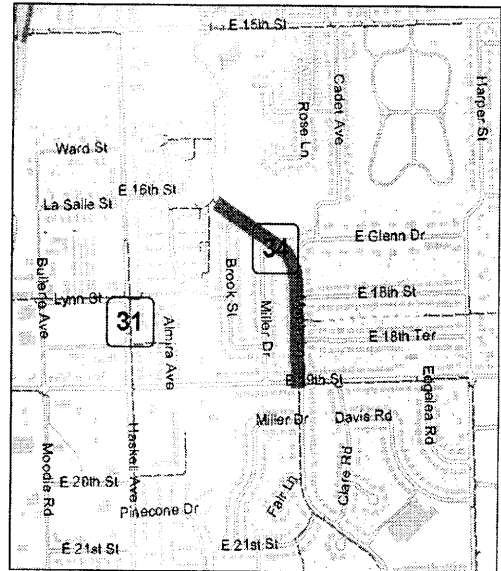
[illegible][illegible]

PROJECT TITLE: 16th Street
Kentucky to Rhode Island
Storm Drainage Improvements

DEPARTMENTAL RESPONSIBILITY: Public Works

Description: This project would improve the existing storm sewer system in this area as recommended in the Stormwater Management Master Plan, 1996.

Justification: This is a critical project where recurring residential or commercial structure flooding is the direct result of the inadequacy of the existing storm drainage system.

Comments: Phase I, Priority Number 10 project in Stormwater Management Master Plan, 1996. This project would be financed with current revenues collected from the stormwater utility fee. Projected construction year is 2014.

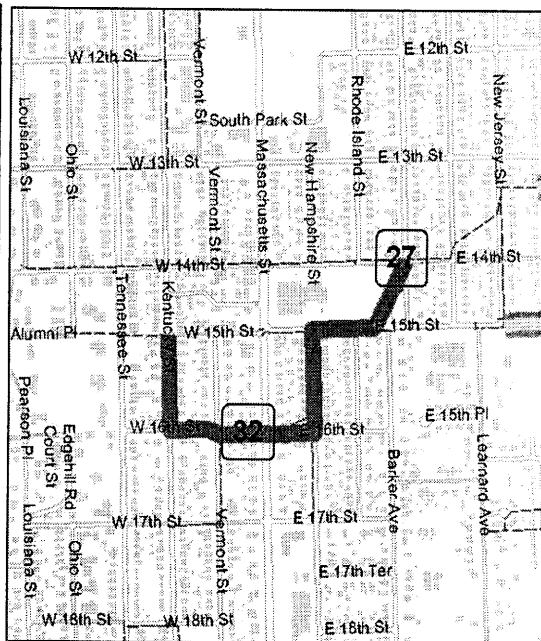
[illegible][illegible]

PROJECT TITLE: W. 11th & Alabama Street
Storm Drainage Improvements

DEPARTMENTAL RESPONSIBILITY: Public Works

Description: This project would improve the capacity of the existing storm sewer system in the area around 11th & Alabama Streets.

Justification: Increased impervious surface from KU parking improvements on the hill west of the KU Stadium has significantly added to the already substantial amounts of stormwater that run onto 11th & Alabama Streets. Stormwater runs east down 11th, then north down Alabama Street, creating a hazardous situation that becomes even more treacherous in winter when ice forms on the roadway.

Comments: This project was submitted by the Oread Neighborhood Association. It is not in the current list of CIP's, but it may be possible to expand a nearby project (CIP #24) to include the area. CIP #24 is a Group 2, Priority Number 24 project in Stormwater Management Master Plan, 1996. Revenue generated from the stormwater fees will not be available to fund this project until after 2020. Projected costs are for CIP #24 project as shown in the Stormwater Master Plan.

[illegible][illegible]

PUBLIC WORKS DEPARTMENT PROJECTS

(Bike Lanes)

PROJECT TITLE McDONALD DRIVE REC PATH N. IOWA - LAKEVIEW RD. BIKE LANE

DEPARTMENTAL RESPONSIBILITY: Public Works

Description: Construct a ten (10) feet wide "RecPath" along the existing public right-of-way of McDonald Drive and N. Iowa. The facility will require one culvert to provide passage over the existing open drainage.

Justification: The RecPath (multi-use path) would connect Rockledge Rd. to the street stub of N. Iowa Street, two planned "BikeLane" facilities. Completion of this project would benefit bicyclists who ride the Farmer's Turnpike, often connecting with the South Lawrence Trafficway RecPath. The project would also provide a needed north-south passage for residents living south of 6th Street to the industrial park along North Iowa Street and Lakeview Road.

Comments: The construction of bike lanes will require prohibiting of on-street parking prior to construction.

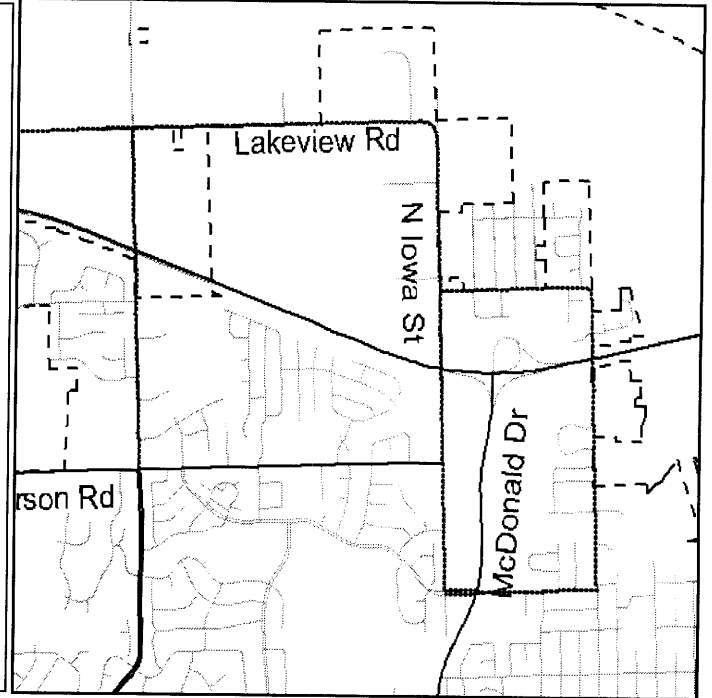

EXPENDITURE SCHEDULE (\$000,S)

PROJECT ELEMENT	TOTAL	THRU 2004	2005	2006	2007	2008	2009	2010	BEYOND 2010
PLANNING									
DESIGN									
LAND									
CONSTRUCTION	146			146					
EQUIPMENT									
2% FOR ARTS									
OTHER									
TOTAL	146			146					

FUNDING SCHEDULE (\$000,S)

SOURCE	TOTAL	THRU 2004	2005	2006	2007	2008	2009	2010	BEYOND 2010
G. O. BONDS	146			146					
SPECIAL ASSMT.									
REVENUE BONDS									
CURRENT REV.									
FEDERAL AID									
STATE AID									
EX. BONDS									
OTHER									
TOTAL	146			146					

PROJECT TITLE 15TH STREET BIKE LANES CONNECTICUT ST. TO CITY LIMITS

DEPARTMENTAL RESPONSIBILITY:

Public Works

Description: Construct 1.2 meter (4') wide bike lanes on each side of the roadway. The roadway would be signed with regulatory black and white signs indicating a bike only lane. Additionally, regulatory adhesive symbols will be placed on the pavement at intervals of 92.5 meters (300').

Justification: This facility would provide a needed east-west corridor of mobility. This roadway is identified in the "Planned Bikeway Map" as a future "BikeLane" facility.

Comments: The construction of bike lanes will require prohibiting of on-street parking prior to construction.

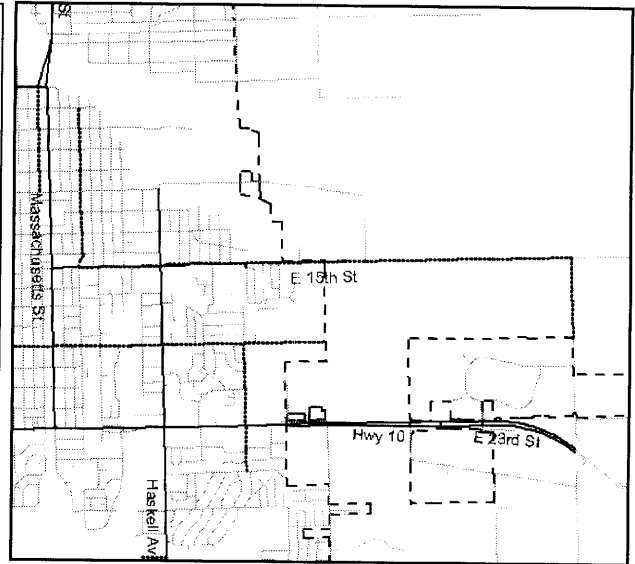

EXPENDITURE SCHEDULE (\$000,S)									
PROJECT ELEMENT	TOTAL	THRU 2004	2005	2006	2007	2008	2009	2010	BEYOND 2010
PLANNING									
DESIGN	13					13			
LAND									
CONSTRUCTION	135					135			
EQUIPMENT									
2% FOR ARTS									
OTHER									
TOTAL	148					148			

FUNDING SCHEDULE (\$000,S)									
SOURCE	TOTAL	THRU 2004	2005	2006	2007	2008	2009	2010	BEYOND 2010
G. O. BONDS	148					148			
SPECIAL ASSMT.									
REVENUE BONDS									
CURRENT REV.									
FEDERAL AID									
STATE AID									
EX. BONDS									
OTHER									
TOTAL	148					148			

PROJECT TITLE 19TH STREET BIKE LANES BARKER AVE. TO HASKELL AVE.

DEPARTMENTAL RESPONSIBILITY:

Public Works

Description: Construct 1.2 meter (4') wide bike lanes on each side of the roadway. The roadway would be signed with regulatory black and white signs indicating a bike only lane. Additionally, regulatory adhesive symbols will be placed on the pavement at intervals of 92.5 meters (300').

Justification: This facility would provide a needed east-west corridor of mobility. This roadway is identified in the "Planned Bikeway Map" as a future "BikeLane" facility.

Comments: The construction of bike lanes will require prohibiting of on-street parking prior to construction.

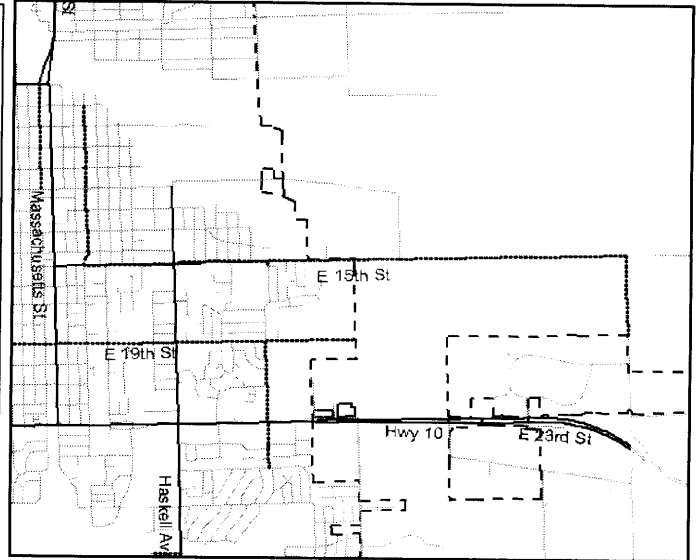

EXPENDITURE SCHEDULE (\$000,S)									
PROJECT ELEMENT	TOTAL	THRU 2004	2005	2006	2007	2008	2009	2010	BEYOND 2010
PLANNING									
DESIGN	8				8				
LAND									
CONSTRUCTION	82				82				
EQUIPMENT									
2% FOR ARTS									
OTHER									
TOTAL	90				90				

FUNDING SCHEDULE (\$000,S)									
SOURCE	TOTAL	THRU 2004	2005	2006	2007	2008	2009	2010	BEYOND 2010
G. O. BONDS	90				90				
SPECIAL ASSMT.									
REVENUE BONDS									
CURRENT REV.									
FEDERAL AID									
STATE AID									
EX. BONDS									
OTHER									
TOTAL	90				90				

PROJECT TITLE NAISMITH DRIVE BIKE LANES SUNNYSIDE DR. TO W. 23RD ST.

DEPARTMENTAL RESPONSIBILITY: Public Works

Description: Construct 1.2 meter (4') wide bike lanes on each side of the roadway. The roadway would be signed with regulatory black and white signs indicating a bike only lane. Additionally, regulatory adhesive symbols will be placed on the pavement at intervals of 92.5 meters (300').

Justification: This facility would provide a needed north-south corridor of mobility. This roadway is identified in the "Planned Bikeway Map" as a future "BikeLane" facility.

Comments: The construction of bike lanes will require prohibiting of on-street parking prior to construction.

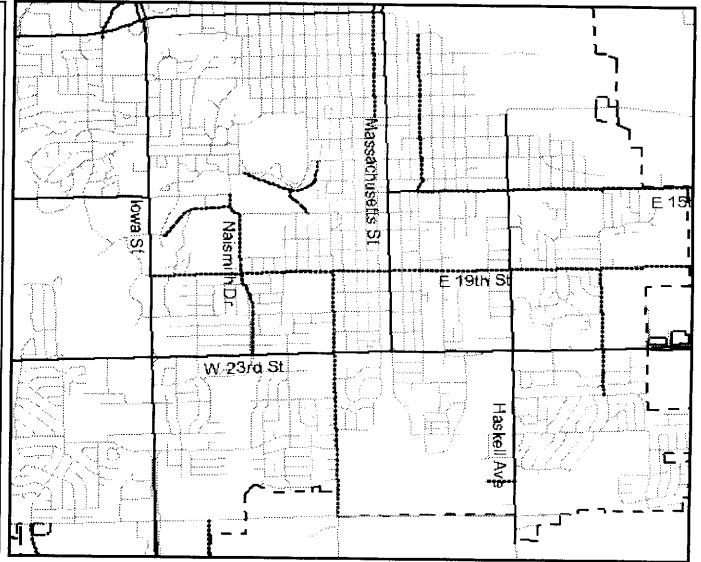

EXPENDITURE SCHEDULE (\$000,S)									
PROJECT ELEMENT	TOTAL	THRU 2004	2005	2006	2007	2008	2009	2010	BEYOND 2010
PLANNING									
DESIGN	5		5						
LAND									
CONSTRUCTION	48		48						
EQUIPMENT									
2* FOR ARTS									
OTHER									
TOTAL	53		53						

FUNDING SCHEDULE (\$000,S)									
SOURCE	TOTAL	THRU 2004	2005	2006	2007	2008	2009	2010	BEYOND 2010
G. O. BONDS	53		53						
SPECIAL ASSMT.									
REVENUE BONDS									
CURRENT REV.									
FEDERAL AID									
STATE AID									
EX. BONDS									
OTHER									
TOTAL	53		53						

PROJECT TITLE: WAKARUSA DR RECREATION PATH
6th ST. to CLINTON PARKWAY

DEPARTMENTAL RESPONSIBILITY:

Public Works

Description: Construct a ten (10) feet wide "RecPath" along the existing Wakarusa Drive right-of-way.

Justification: The intensive commercial, office, industrial and multi-family development along Wakarusa Drive northwest area justifies a separated multi-use RecPath. The RecPath should extend from the existing SLT RecPath north to 6th Street.

Comments: This project could be financed over four years or if approved for Transportation Enhancement funding the project could be financed in one year for less than it would cost if it is spread out over four years.

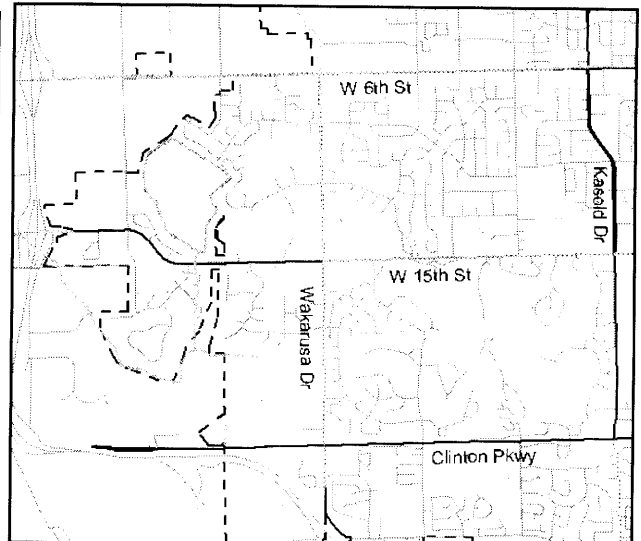

EXPENDITURE SCHEDULE (\$000, S)

[illegible]

FUNDING SCHEDULE (\$000, S)	
1990	1991
1992	1993
1994	1995
1996	1997
1998	1999
2000	2001
2002	2003
2004	2005
2006	2007
2008	2009
2010	2011
2012	2013
2014	2015
2016	2017
2018	2019
2020	2021
2022	2023
2024	2025
2026	2027
2028	2029
2030	2031
2032	2033
2034	2035
2036	2037
2038	2039
2040	2041
2042	2043
2044	2045
2046	2047
2048	2049
2050	2051
2052	2053
2054	2055
2056	2057
2058	2059
2060	2061
2062	2063
2064	2065
2066	2067
2068	2069
2070	2071
2072	2073
2074	2075
2076	2077
2078	2079
2080	2081
2082	2083
2084	2085
2086	2087
2088	2089
2090	2091
2092	2093
2094	2095
2096	2097
2098	2099
2100	2101
2102	2103
2104	2105
2106	2107
2108	2109
2110	2111
2112	2113
2114	2115
2116	2117
2118	2119
2120	2121
2122	2123
2124	2125
2126	2127
2128	2129
2130	2131
2132	2133
2134	2135
2136	2137
2138	2139
2140	2141
2142	2143
2144	2145
2146	2147
2148	2149
2150	2151
2152	2153
2154	2155
2156	2157
2158	2159
2160	2161
2162	2163
2164	2165
2166	2167
2168	2169
2170	2171
2172	2173
2174	2175
2176	2177
2178	2179
2180	2181
2182	2183
2184	2185
2186	2187
2188	2189
2190	2191
2192	2193
2194	2195
2196	2197
2198	2199
2200	2201
2202	2203
2204	2205
2206	2207
2208	2209
2210	2211
2212	2213
2214	2215
2216	2217
2218	2219
2220	2221
2222	2223
2224	2225
2226	2227
2228	2229
2230	2231
2232	2233
2234	2235
2236	2237
2238	2239
2240	2241
2242	2243
2244	2245
2246	2247
2248	2249
2250	2251
2252	2253
2254	2255
2256	2257
2258	2259
2260	2261
2262	2263
2264	2265
2266	2267
2268	2269
2270	2271
2272	2273
2274	2275
2276	2277
2278	2279
2280	2281
2282	2283
2284	2285
2286	2287
2288	2289

[illegible]

PROJECT TITLE: South Lawrence Trafficway
Recreation Trails System

DEPARTMENTAL RESPONSIBILITY: Public Works

Description: Construction of a 10 feet wide bicycle path and pedestrian trail along the South Lawrence Trafficway around the southeast and south perimeter of the city.

Justification: Provide for an alternative mode of surface transportation around the City of Lawrence.

Comments: A portion of the alignment will function as a segment of the American Discovery Trail and the State Heritage Trails system, which is proposed to traverse Kansas as a part of the National Scenic Trail System. Phase I (Kansas Turnpike (I-70) to U.S. Highway 59) is complete. **Phase II** (U.S. Highway 59 east to Highway 10) awaits final determination on the east alignment of the SLT.

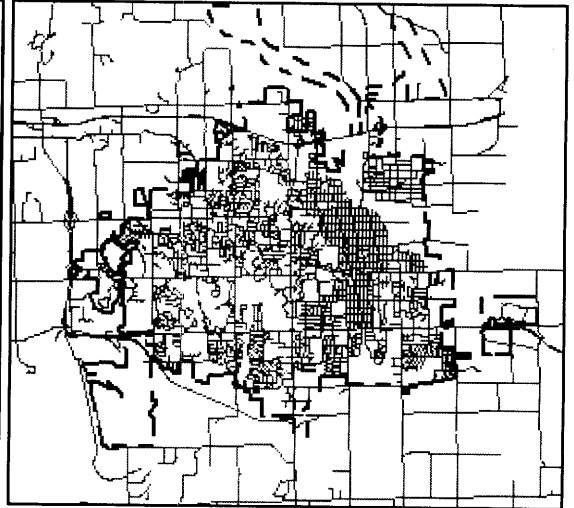
[illegible][illegible]

PROJECT TITLE: WEST 9TH STREET BIKE LANES
KENTUCKY ST TO MISSISSIPPI ST

DEPARTMENTAL RESPONSIBILITY: Public Works

Description: Construct new curbs along the south side of 9th Street if necessary to accomodate four 11' auto lanes, a 4' bicycle lane on the south side adjacent to the curb, a nd a 4' bicycle lane to the left of the parking on the north side of the street.

Justification: This is an important bike lane corridor between KU via Mississippi Street and Downtown. It is both a destination of itself with many student oriented businesses, and a link for bicyclists.

Comments: The Traffic Safety Commission reviewed this request several years ago and voted not to recommend it. The request was submitted by Michael Almon in 2002 for the 2003-2008 Capital Improvements Plan.

EXPENDITURE SCHEDULE (\$000,S)									
PROJECT ELEMENT	TOTAL	THRU 2004	2005	2006	2007	2008	2009	2010	BEYOND 2010
PLANNING									
DESIGN	25						25		
LAND									
CONSTRUCTION	250						250		
EQUIPMENT									
2% FOR ARTS									
OTHER									
TOTAL	275						275		

FUNDING SCHEDULE (\$000,S)									
SOURCE	TOTAL	THRU 2004	2005	2006	2007	2008	2009	2010	BEYOND 2010
G. O. BONDS	275						275		
SPECIAL ASSMT.									
REVENUE BONDS									
CURRENT REV.									
FEDERAL AID									
STATE AID									
EX. BONDS									
OTHER									
TOTAL	275						275		

PUBLIC WORKS DEPARTMENT PROJECTS

(Miscellaneous Projects)

PROJECT TITLE: VEHICLE MAINTENANCE CENTRAL GARAGE ADDITION

DEPARTMENTAL RESPONSIBILITY: Public Works

Description: Enlarge the existing vehicle maintenance building at E. 11th and Haskell Avenue to provide additional maintenance stalls for city vehicles.

Justification: Additional work space is needed to maintain the city's fleet of vehicles.

Comments: If Wakarusa site develops as planned, this addition may not be as critical.

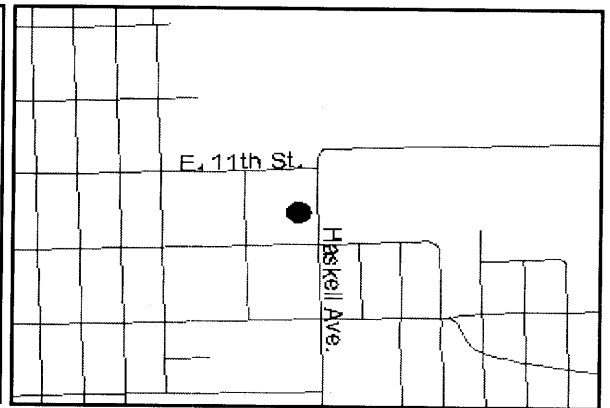

EXPENDITURE SCHEDULE (\$000,S)									
PROJECT ELEMENT	TOTAL	THRU 2004	2005	2006	2007	2008	2009	2010	BEYOND 2010
PLANNING									
DESIGN	40				40				
LAND									
CONSTRUCTION	352				352				
EQUIPMENT									
2% FOR ARTS	8				8				
OTHER									
TOTAL	400				400				

FUNDING SCHEDULE (\$000,S)									
SOURCE	TOTAL	THRU 2004	2005	2006	2007	2008	2009	2010	BEYOND 2010
G. O. BONDS	400				400				
SPECIAL ASSMT.									
REVENUE BONDS									
CURRENT REV.									
FEDERAL AID									
STATE AID									
EX. BONDS									
OTHER									
TOTAL	400				400				

PROJECT TITLE: Satellite Public Works Department Facility

DEPARTMENTAL RESPONSIBILITY: Public Works

Description: Construct office and storage facilities on the City owned property to the north of the Clinton Water Treatment Plant along Wakarusa Drive.

Justification: Due to the continued growth of the City, the current location at E. 11th and Haskell Avenue cannot effectively and efficiently serve the entire city.

Comments: A Public Works facility on the west side of the city would improve our ability to serve the citizens.

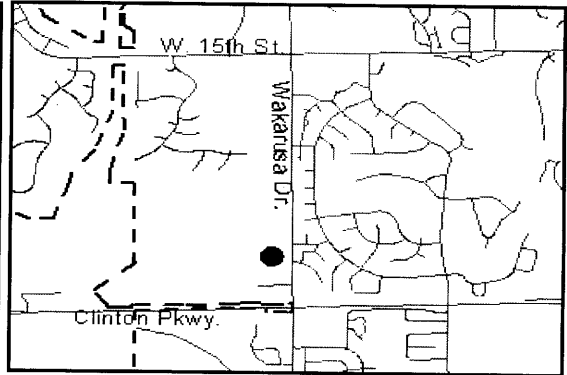

EXPENDITURE SCHEDULE (\$000,S)									
PROJECT ELEMENT	TOTAL	THRU 2004	2005	2006	2007	2008	2009	2010	BEYOND 2010
PLANNING									
DESIGN	40		40						
LAND									
CONSTRUCTION	1920		1920						
EQUIPMENT									
2% FOR ARTS	40		40						
OTHER									
TOTAL	2000		2000						

FUNDING SCHEDULE (\$000,S)									
SOURCE	TOTAL	THRU 2004	2005	2006	2007	2008	2009	2010	BEYOND 2010
G. O. BONDS	2000		2000						
SPECIAL ASSMT.									
REVENUE BONDS									
CURRENT REV.									
FEDERAL AID									
STATE AID									
EX. BONDS									
OTHER									
TOTAL	2000		2000						

PROJECT: Construct New Sidewalks in University Place Neighborhood

DEPARTMENTAL RESPONSIBILITY: Public Works

Description: Construct approximately 1,293 linear feet of sidewalk to complete a pedestrian network in the University Place Neighborhood.

Justification: There are four blocks in the neighborhood that do not have any sidewalk on either side of the street. These blocks are the 1700 block of Alabama, 1800 block of Mississippi Street, 1800 block of Missouri Street, and W. 18th Street between Maine and Missouri Street. The neighborhood receives significant pedestrian traffic because of its proximity to the main campus at KU and Lawrence High School.

Comments: This project is submitted by the University Place Neighborhood Association. See attached communications for further details and supporting documentation on this project.

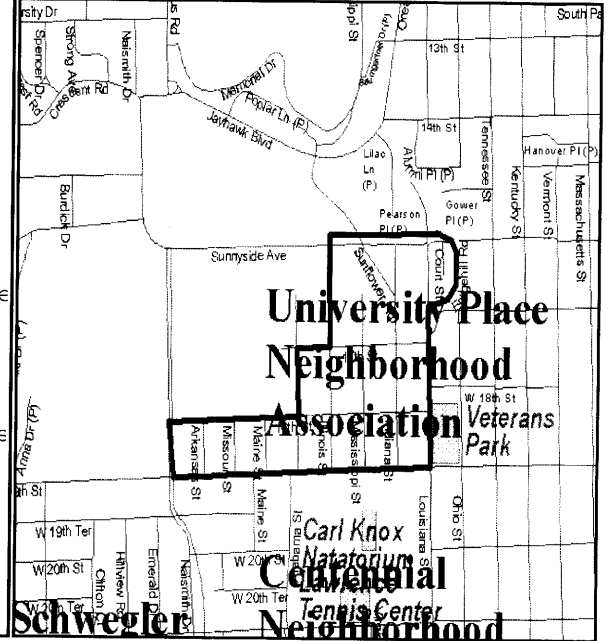

EXPENDITURE SCHEDULE (\$000,S)

PROJECT ELEMENT	TOTAL	THRU 2004	2005	2006	2007	2008	2009	2010	BEYOND 2010
PLANNING									
DESIGN									
LAND									
CONSTRUCTION	40		40						
EQUIPMENT									
2% FOR ARTS									
OTHER									
TOTAL	40		40						

FUNDING SCHEDULE (\$000,S)

SOURCE	TOTAL	THRU 2004	2005	2006	2007	2008	2009	2010	BEYOND 2010
G. O. BONDS	40		40						
SPECIAL ASSMT.									
REVENUE BONDS									
CURRENT REV.									
FEDERAL AID									
STATE AID									
EX. BONDS									
OTHER									
TOTAL	40		40						