

K:\Projects\Lawrence Douglas County Fire & Medical\Drawings\Planting\506a-Board2.dwg  
Date: 12/20/2014 10:47am  
User: N:\Users\Customers\paul.becman\Planting\506a-Board2.dwg



Legal Description

LOTS 4 AND 5, FRATERNITY PLACE, A SUBDIVISION IN THE CITY OF LAWRENCE, DOUGLAS COUNTY, KANSAS, AND LYING IN THE SOUTHEAST QUARTER OF SECTION 1, TOWNSHIP 13 SOUTH, RANGE 19 EAST OF THE SIXTH PRINCIPAL MERIDIAN.

Location Map

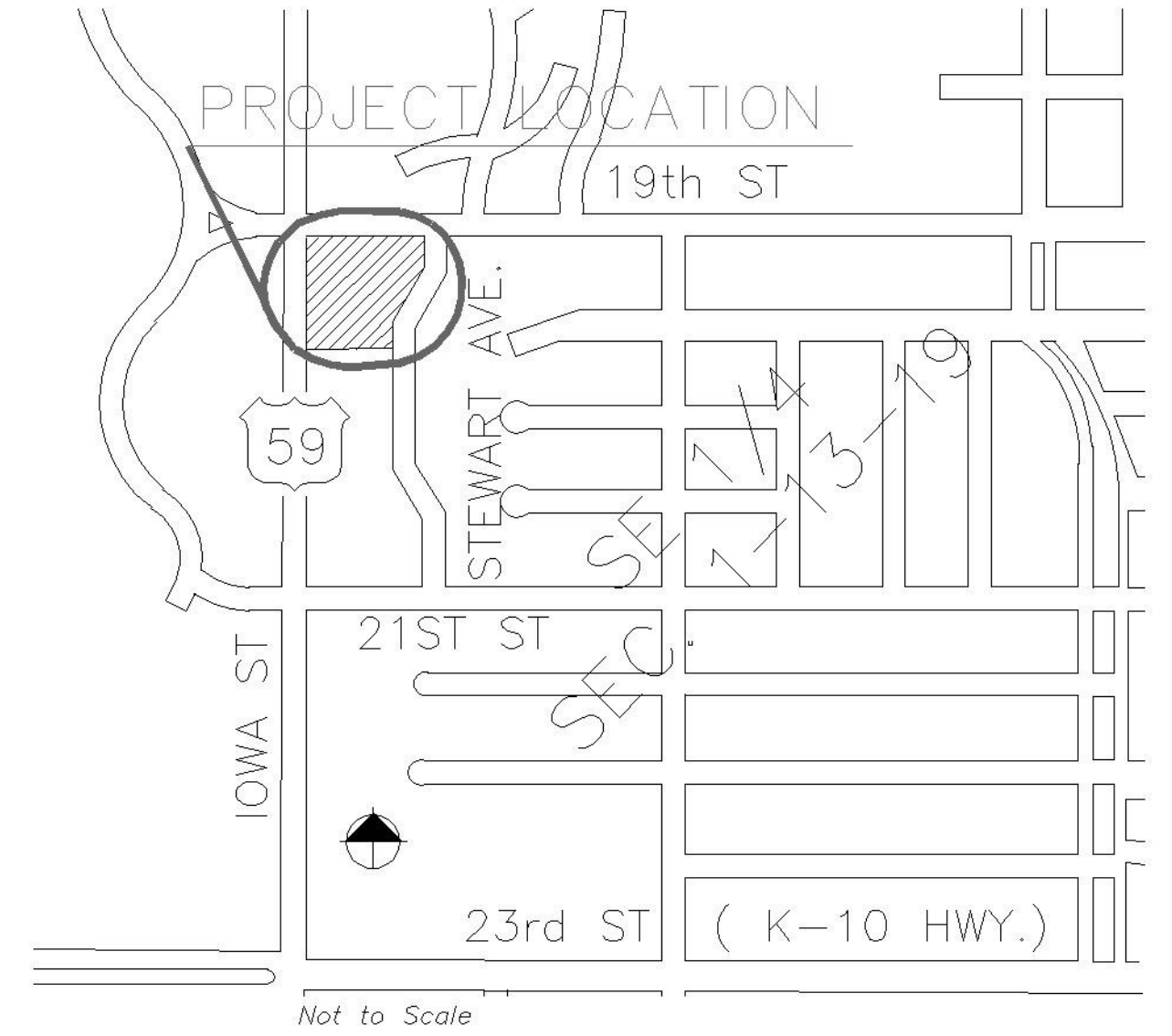

Notes

- DEVELOPER: Lawrence Douglas County Fire & Medical  
City of Lawrence  
Lawrence, Kansas 66044
- LANDSCAPE ARCHITECT: Haldeman Landscape Architecture, Inc., 1842 Clarkson Street, Denver, CO 80218.
- ENGINEER/SURVEYOR: Landplan Engineering, P.A., 1310 Wakarusa Dr., Lawrence, Kansas, 66049.
- Topographic information obtained from field survey performed by Landplan Engineering, July 2004.
- Zoning: RD
- Existing, mature Austrian Pine trees located adjacent to 19th Street and Iowa Street are to remain and be considered street trees. The number of existing Austrian Pines with proposed Norway Spruce along 19th Street meet the minimum number of street trees required by city code. The number of existing Austrian Pines with proposed Norway Spruce along Iowa Street exceeds the minimum number of street trees required by city code.
- The number of proposed trees for the interior of the site (51) exceeds the minimum number of trees (10) required by city code.
- All disturbed ground area will be seeded or planted. All existing turfgrass areas beyond the construction limits, but within the property, will be overseeded with same turfgrass seed mix applied to disturbed areas.
- All disturbed landscape areas and proposed plants will be irrigated.
- All existing trees to remain will be preserved and protected during construction as per the City of Lawrence city code.
- All existing trees to remain and be preserved are Austrian Pine trees approximately 20' in height. Proposed ground cover plants will be spaced to completely cover the ground surface within the intended planting bed area within one growing season.
- Locations of trees shown in paved areas may change to coordinate with final pavement design.
- Changes to this preliminary planting plan in response to city recommendations include species changes (White Oak to Swamp White Oak and Austrian Pine to Norway Spruce), additional tree species (Sycamore, Bur Oak, and Thornless Hawthorn), additional quantity of trees within the interior of the site, and reconfiguration of street trees adjacent to Stewart Avenue.

Plant Schedule

ITEM	QUAN	COMMON NAME	BOTANICAL NAME	SIZE	CONDITION	NOTES
Trees						
1.	21	River Birch	Betula nigra	1" cal.	B&B	
2.	9	Redbud	Cercis canadensis	1" cal.	B&B	
3.	9	Norway Spruce	Picea abies	6' hgt.	B&B	
4.	6	Bloodgood London Planetree	Platanus x acerifolia 'Bloodgood'	1" cal.	B&B	
5.	9	Swamp White Oak	Quercus bicolor	1" cal.	B&B	
6.	16	Bur Oak	Quercus macrocarpa	1" cal.	B&B	
Shrubs						
7.	3	Raspberry	Rubus sp.	5 gal.	Container	Set approx. 5' o.c.
Ground Covers						
8.	700	Liriope	Liriope muscari	4" pot	Container	Set @ 12" o.c.

Turfgrass Seed Mix

ITEM	COMMON NAME	BOTANICAL NAME	% OF MIX	NOTES
1.	Annual Ryegrass	Lolium sp.	20	Variety and pounds of PLS specified in construction drawings (future)
2.	K-31 Tall Fescue	Festuca sp.	50	Variety and pounds of PLS specified in construction drawings (future)
3.	Kentucky Bluegrass	Poa pratensis	30	Variety and pounds of PLS specified in construction drawings (future)

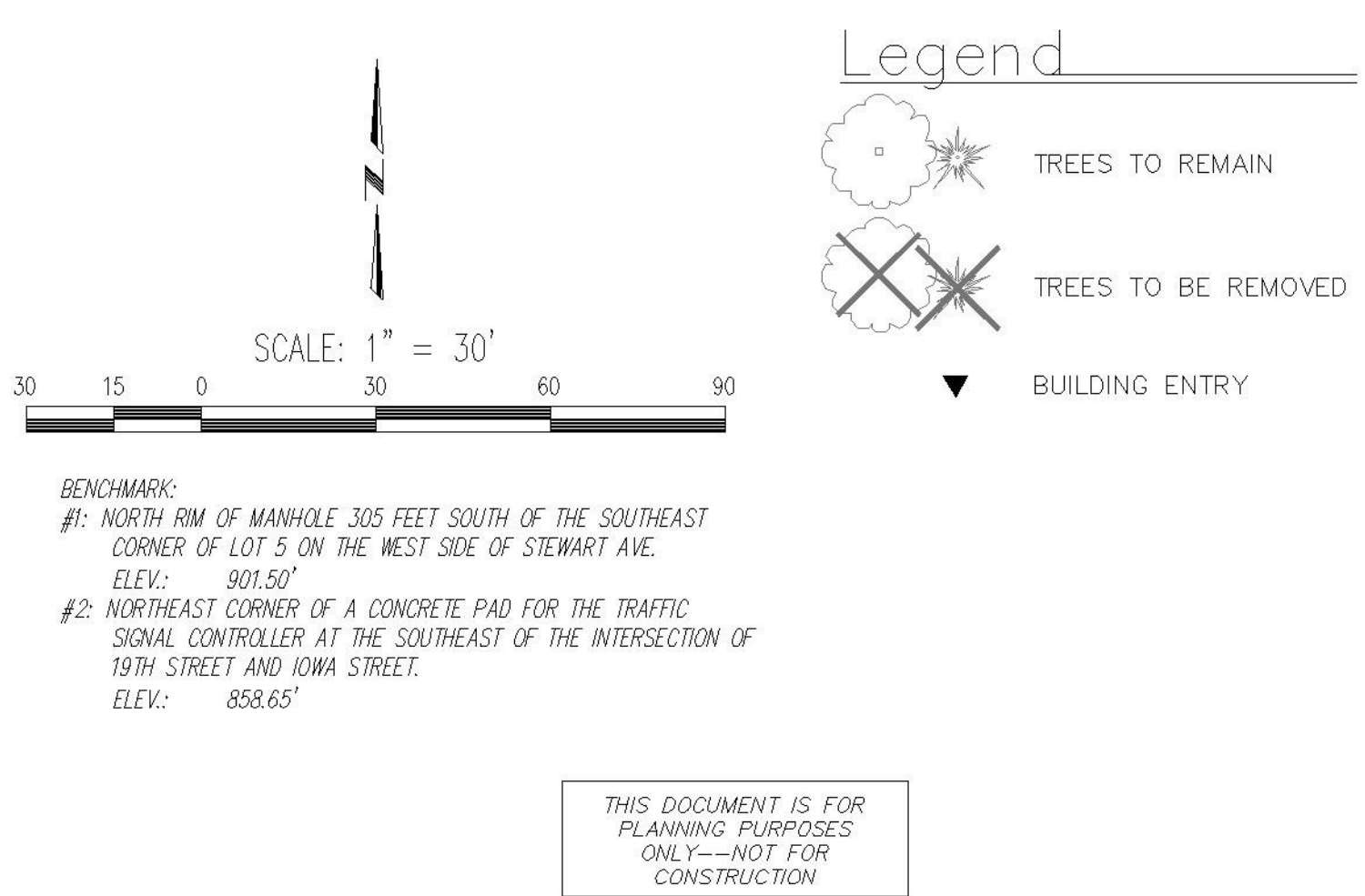

Preliminary Planting Plan for  
CITY OF LAWRENCE  
FIRE STATION #5  
Lawrence, Kansas

Project:  
sabatini  
architects  
INC.  
805-A NEW HAMPSHIRE STREET  
LAWRENCE, KANSAS 66094  
V. 785.331.3399 F. 785.331.0846  
www.sabatiniarchitects.com

SHAUGHNESSY, FICKLE &  
SCOTT ARCHITECTS INC.  
1150 GRAND BLVD., SUITE 400  
KANSAS CITY, MISSOURI 66105  
V. 816.474.1357 F. 816.421.8024  
www.sfsarch.com

HLA  
Haldeman Landscape Architecture  
1842 CLARKSON STREET  
DENVER, COLORADO 80218  
V. 303.850.1188 F. 303.850.1199  
mhaldeman@earthlink.net

Landplan Engineering, P.A.  
Civil Engineering  
Landscape Architecture  
Community Planning  
Surveying  
1310 Wakarusa Drive  
Lawrence, Kansas 66049  
Tel: 785.331.3399  
Fax: 785.331.0846  
www.landplaneng.com

BOB D. CAMPBELL & CO.  
4338 Bellevue, Kansas City MO 64111  
(tel) 816.531.4144 (fax) 816.531.8572

CMG  
FIRE PROTECTION  
ENGINEERING, INC.  
10727 W. 128TH STREET  
OVERLAND PARK, KS 66213  
P. 913.239.8900  
F. 913.239.8901

Revisions:  
9.27.04 per city comments  
10.12.04 per city comments

Issue Date:  
Scale: 1" = 30'  
Project No.:  
Drawn By: MLH  
Checked By:  
Title: PLANTING PLAN

Sheet No.: