

David Woosley

From: Carol [seemeteach@yahoo.com]
Sent: Thursday, September 23, 2004 1:45 PM
To: traffic@ci.lawrence.ks.us
Cc: rgamill@usd497.org
Subject: request for traffic study at Peterson & Arrowhead

Please consider this request for a traffic study to be conducted at the intersection of Peterson and Arrowhead Dr. Currently there are posted crosswalk signs and painted crosswalk lines at the intersection.

The speed of vehicles at all times of day on Peterson road is extremely dangerous, but particularly so before start the start time at Deerfield Elementary (7:40-8:00 a.m.). Many parents have attempted to walk children to school and with the dangerous crossing, have resorted to driving their children every day (myself included).

Thank you for your efforts in keeping our city a safe place to live.

Sincerely,
Carol Ann Harrell
528 Arrowhead Dr.
843-1446

Do you Yahoo!?
[Yahoo! Mail](#) - 50x more storage than other providers!

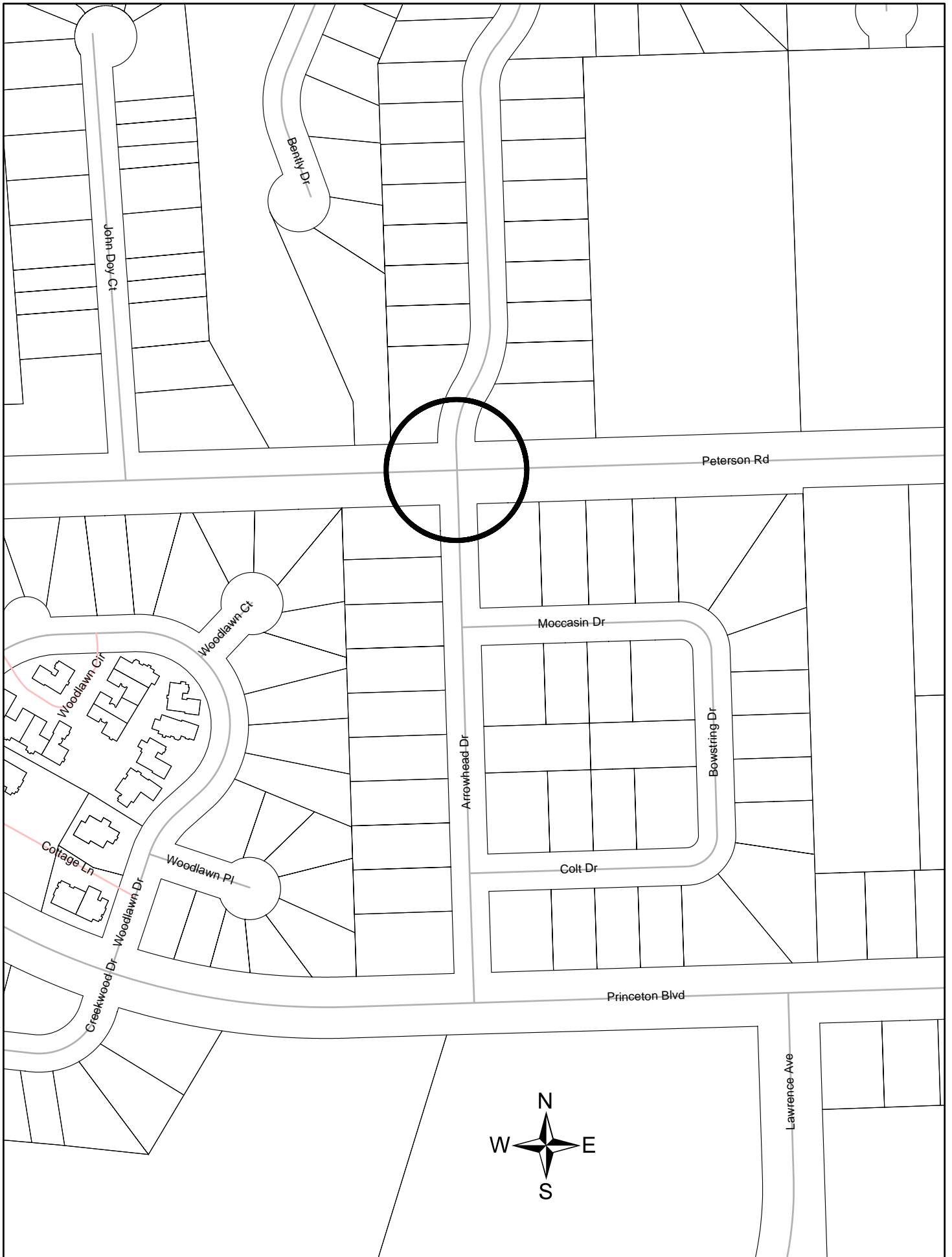



CITY OF LAWRENCE

TRAFFIC ENGINEERING DIVISION

SCHOOL CROSSING GAP STUDY



Location: **Arrowhead Drive & Peterson Road**

Time Period	Date / Weather						Average Gaps Per Minute	Average No. of Elementary Students
	25-Oct-04 sunny, 49°		29-Oct-04 cloudy, 70°		4-Nov-04 sunny, 40°			
	Gaps per minute / Students							
7:15-7:20	0.6	0	1.4	0	1.2	3	1.07	1.00
7:20-7:25	0.6	2	1.4	2	0.8	0	0.93	1.33
7:25-7:30	0.4	0	0.2	0	1.2	0	0.60	0.00
7:30-7:35	0.2	0	0.8	0	0.6	2	0.53	0.67
7:35-7:40	0.6	2	0.6	2	0.8	0	0.67	1.33
7:40-7:45	0.8	3	0.2	1	0.8	1	0.60	1.67
7:45-7:50	0.8	4	0.1	3	0.4	2	0.43	3.00
7:50-7:55	0.6	2	0.3	4	0.8	3	0.57	3.00
7:55-8:00	0.6	1	0.2	0	0.4	0	0.40	0.33



CITY OF LAWRENCE

TRAFFIC ENGINEERING DIVISION

SCHOOL CROSSING GAP STUDY



Location: **Arrowhead Drive & Peterson Road**

Time Period	Date / Weather						Average Gaps Per Minute	Average No. of Elementary Students
	25-Oct-04 sunny, 68°		29-Oct-04 sunny, 68°		4-Nov-04 sunny, 58°			
	Gaps per minute / Students							
3:00-3:05	0.6	0	0.8	0	1	0	0.80	0.00
3:05-3:10	1.0	3	1.2	4	0.8	2	1.00	3.00
3:10-3:15	0.6	9	0.6	12	0.6	14	0.60	11.67
3:15-3:20	1.6	3	0.4	4	1.2	6	1.07	4.33
3:20-3:25	1.0	1	0.8	0	0.8	0	0.87	0.33
3:25-3:30	1.0	0	0.6	0	0.2	0	0.60	0.00