

5 July 2005

Traffic Safety Commission
P.O. Box 708
Lawrence, Kansas 66044

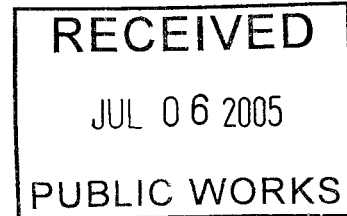

To Whom It May Concern:

Our names are Dan and Carol Abrahamson, and we have lived at 944 Lawrence Avenue since 1963. There is a problem with the traffic in front of our home: the posted speed limit is 25 mph, but we observe daily, many who drive (in our estimation) upwards of 50 mph on Lawrence Avenue between 9th Street and Harvard.

On occasion, we have called the police department about this problem, and they have willingly come out with their radar to slow things down. But as soon as the radar is gone, the speeding starts up again. We do not expect the police to constantly monitor our street.

Today I talked with David Woosley, and he recommended that I write to your commission about our problem. We very much like the "speed humps" that are located on Arizona Street between 6th and 8th Streets and wondered if something similar could be used on Lawrence Ave. Mr. Woosley explained that Lawrence Avenue is a "feeder street" and needs to provide proper passage access for firetrucks and ambulances, but that the city does have a "new" type of speed hump that would allow for emergency vehicles to pass safely.

We respectfully request that the traffic safety commission do a study on traffic calming for Lawrence Avenue.

Most sincerely,



Dan and Carol Abrahamson

Cc: David Woosley

PETITION

Date: July 27, 2005

We, the undersigned home owners on Lawrence Avenue, within the area from 9th street to Harvard, do hereby support the construction of a speed bump(s) to slow the flow of traffic.

1. Walter Hicks Johnne Hicks 920 Lawrence Ave
2. Edw L. Brown 926 Lawrence Ave.
3. Carol V. Abrahamson 944 Lawrence Ave.
4. Nelda L Benton 1003 Lawrence Ave.
5. Darwin K Benton 1003 Lawrence Ave
6. ZuScaull 945 Lawrence Ave
7. John Kelley John D. Kelley 927 LAWRENCE AVE.
8. Linnea Stylianou 902 Lawrence Ave
9. Wylkuss 956 L. Ave
10. Treni West 1009 Law Ave.
11. Sarah Jane Vangemeren 1015 Lawrence Ave.
12. Deborah J. Davin 1021 Lawrence Ave.
13. Wm J. H. 1020 Lawrence Ave.
14. Ayle E. Belts 1014 Lawrence Ave

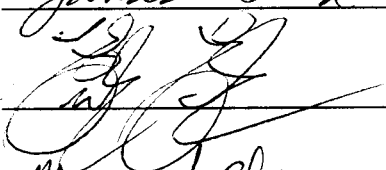
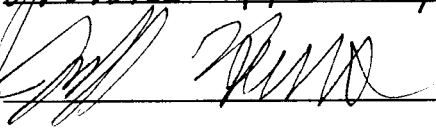
15. Susan A. Beers 1014 Lawrence Ave
16. Janice S. Se 921 Lawrence Ave
17. Don Abrahamson 944 Law. Ave.
18. James Fosl 938 Law Ave.
19.  951 Law Ave
20. Margaret Chapman 939 Lawrence Ave.
21. Bonnie & Peter Neely 933 Lawrence Ave
22.  915 Lawrence Ave.
23. Monica Pett 1008 Lawrence Ave.
24. Hope K. Goldman 1026 Lawrence Ave.
25. Molly Thornburgh 1039 Lawrence Ave.
26. Casey Thornburgh 1039 Lawrence Ave.
27. William M. Cheri 1033 Lawrence Ave.
28. Karen J. Clever 1033 Lawrence Ave
29. _____
30. _____

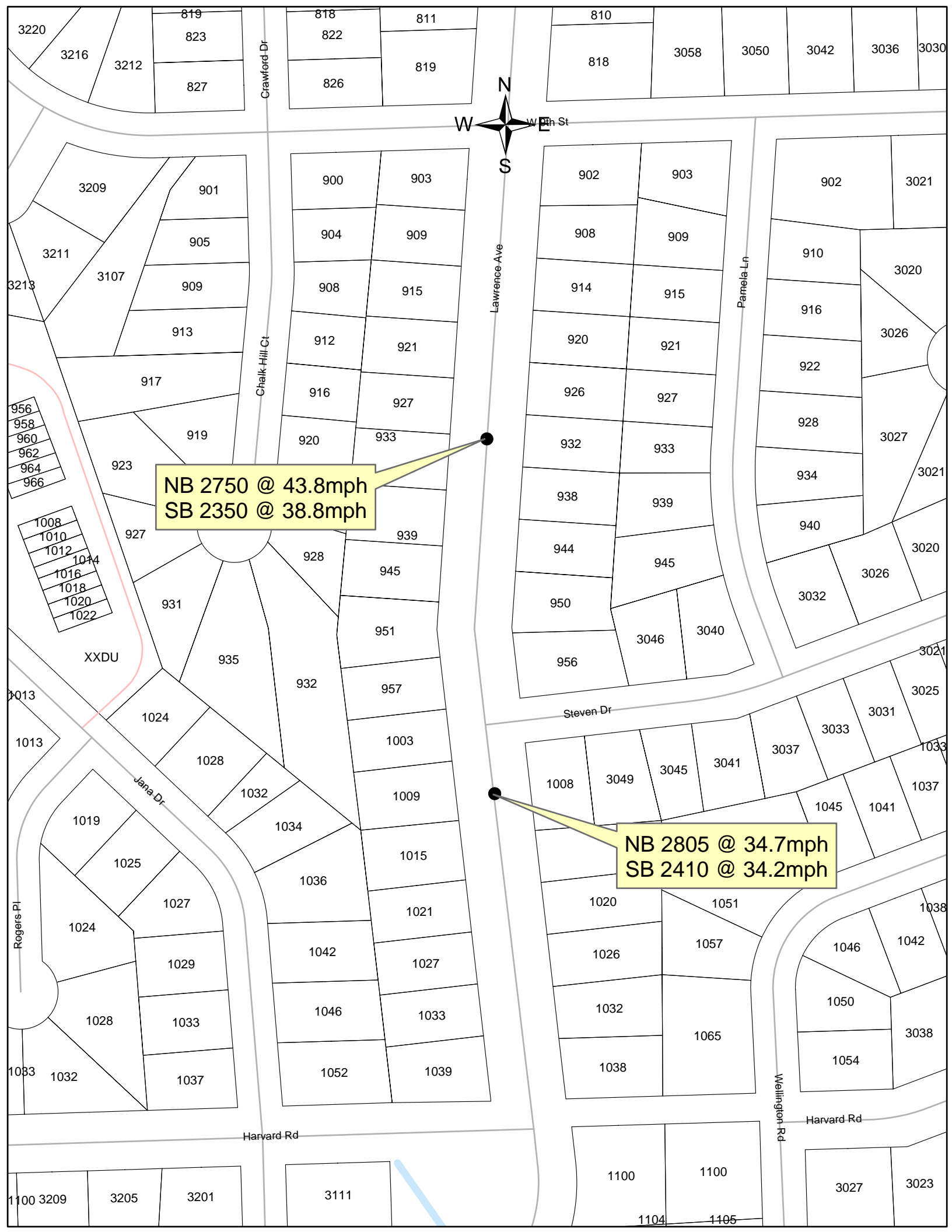

NB 2750 @ 43.8mph
SB 2350 @ 38.8mph

NB 2805 @ 34.7mph
SB 2410 @ 34.2mph