

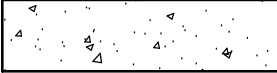



SHEET 11 OF 40

LEGEND

-  10" ASPHALT PAVEMENT (BASE) WITH 2" ASPHALT PAVEMENT (SURFACE)
-  6" REINFORCED CONCRETE SHARED USE PATH
-  TREE REMOVAL

CONSTRUCTION NOTES:

-  RELOCATE POWER POLE SOUTH INTO UTILITY EASEMENT. MAINTAIN MAXIMUM POSSIBLE CLEARANCE FROM WATER LINE.
 -  RELOCATE POWER POLE TO MEDIAN ISLAND EAST OF APPLE LANE.
- WATER VALVE ADJUSTMENTS TO GRADE ARE SUBSIDIARY TO CITY PROJECT UT1105DS WATERLINE INSTALLATION.

DATE	BY	REVISION



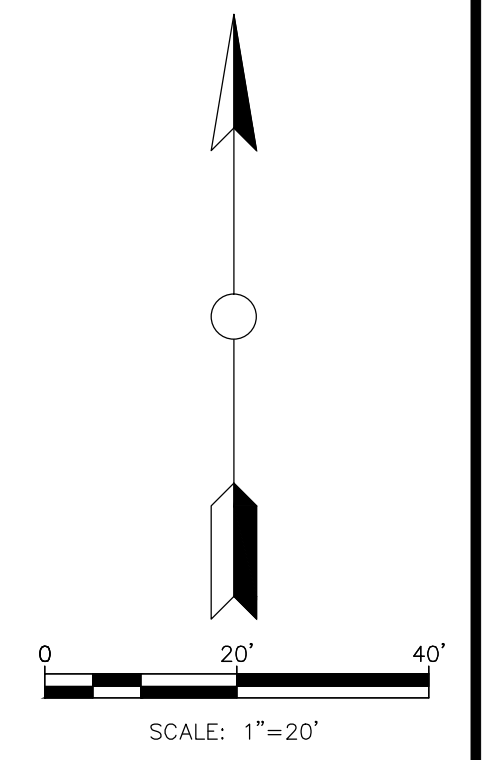
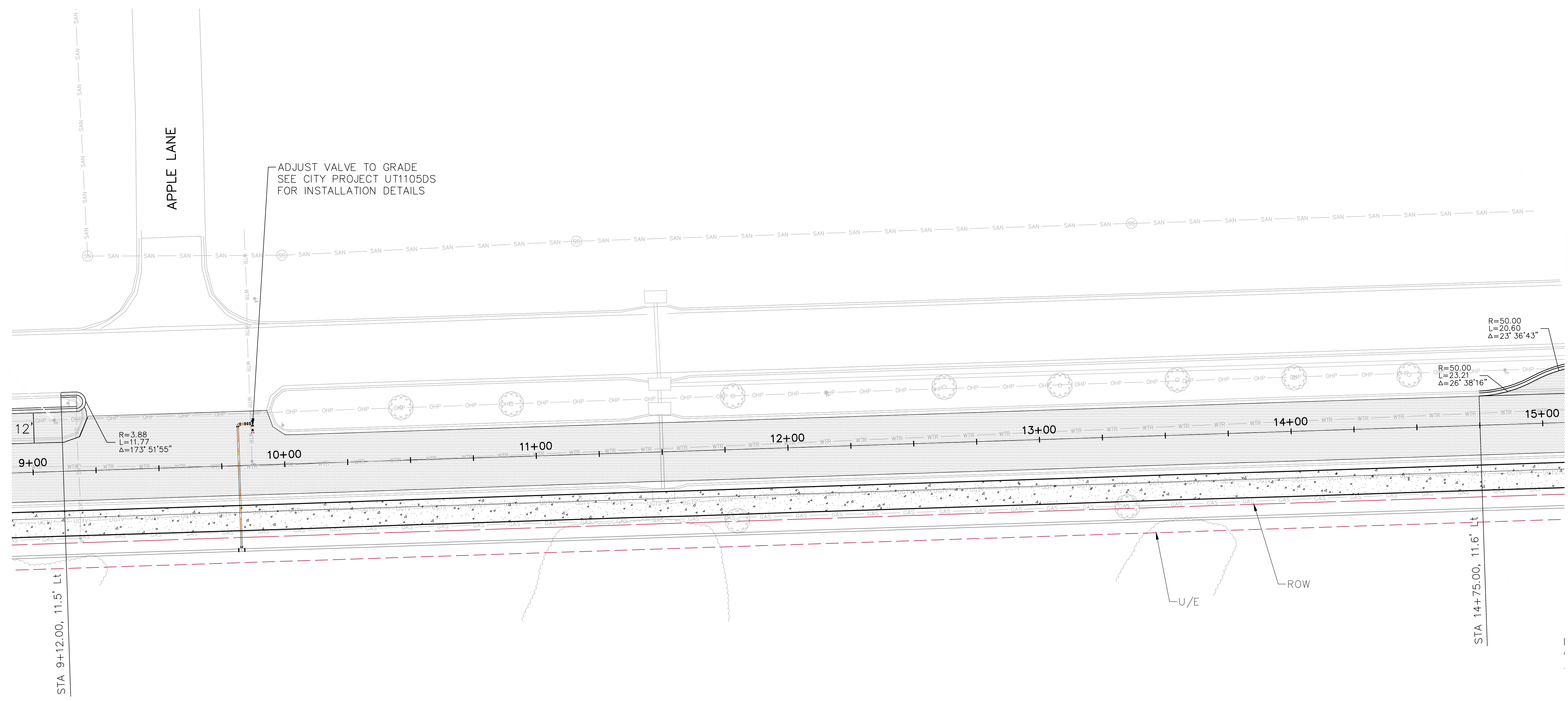

BOB BILLINGS PARKWAY, KASOLD DRIVE TO CRESTLINE DRIVE (EASTBOUND ONLY.)
PLAN SHEET
STA. 3+60.60 TO STA. 9+00
 PROJECT NO. PW1225

DAVID P. CRONIN CITY ENGINEER DAVID L. CORLISS CITY MANAGER

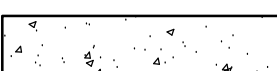

SHEET 12 OF 40

LEGEND

-  10" ASPHALT PAVEMENT (BASE) WITH 2" ASPHALT PAVEMENT (SURFACE)
-  6" REINFORCED CONCRETE SHARED USE PATH
-  TREE REMOVAL

CONSTRUCTION NOTES:

WATER VALVE ADJUSTMENTS TO GRADE ARE SUBSIDIARY TO CITY PROJECT UT1105DS WATERLINE INSTALLATION.

DATE	BY	REVISION



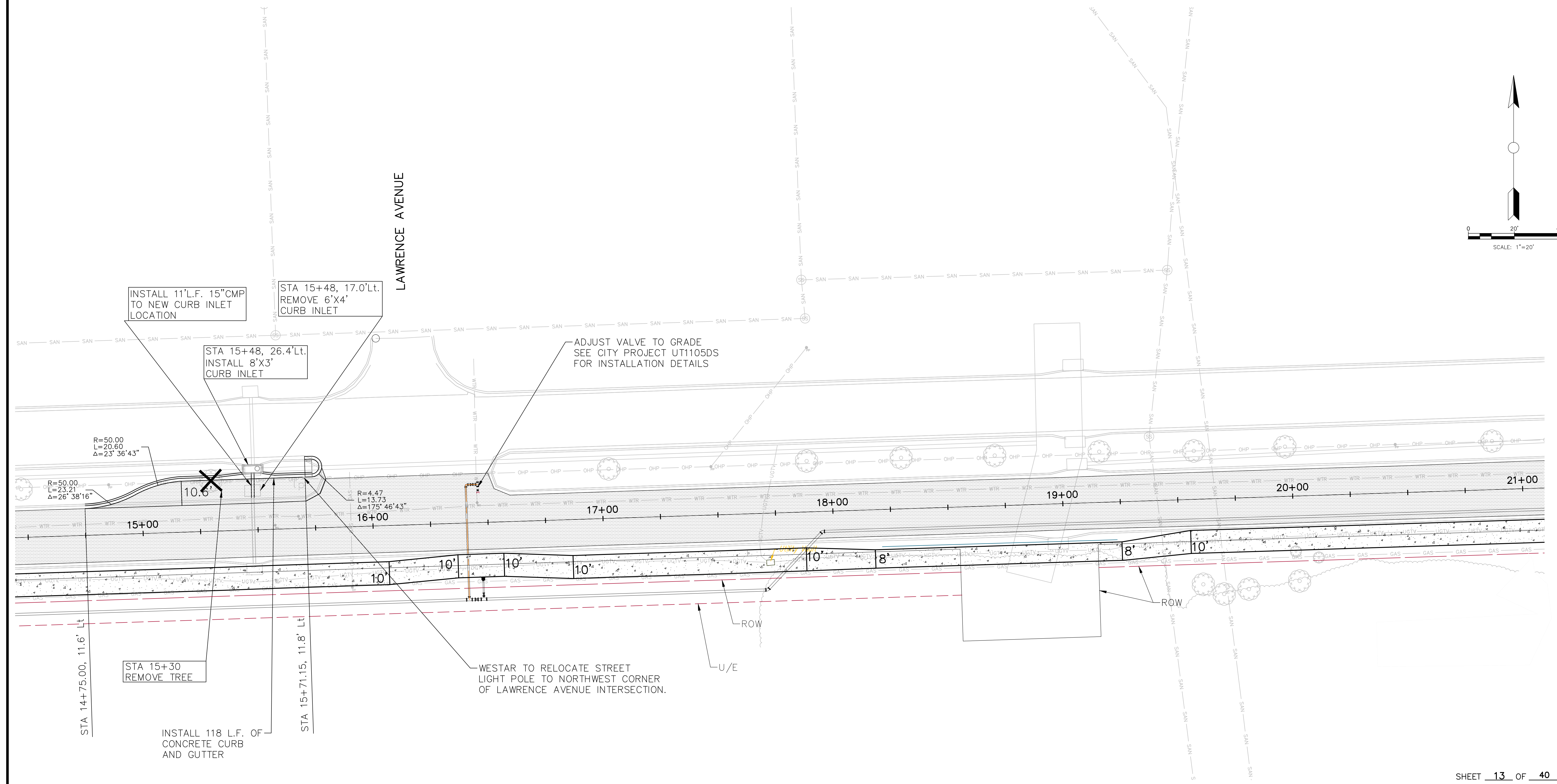
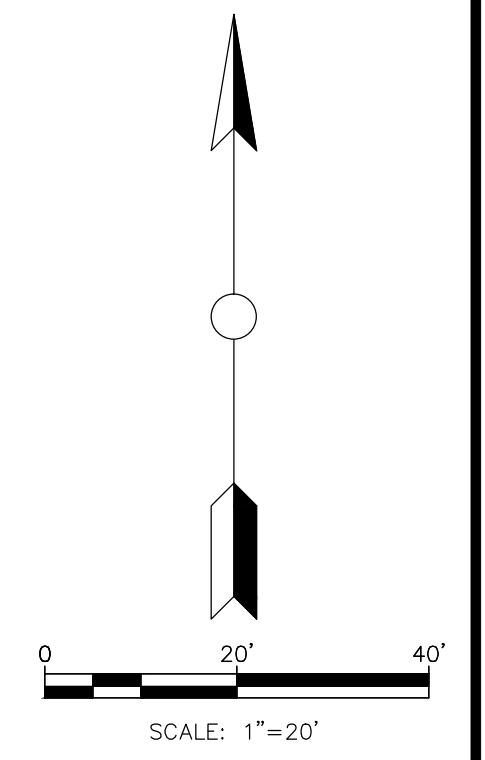

BOB BILLINGS PARKWAY, KASOLD DRIVE TO CRESTLINE DRIVE (EASTBOUND ONLY.)
PLAN SHEET
STA. 9+00 TO STA. 15+00
 PROJECT NO. PW1225

DAVID P. CRONIN CITY ENGINEER DAVID L. CORLISS CITY MANAGER

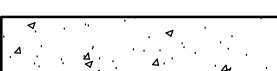

SHEET 13 OF 40

LEGEND

-  10" ASPHALT PAVEMENT (BASE) WITH 2" ASPHALT PAVEMENT (SURFACE)
-  6" REINFORCED CONCRETE SHARED USE PATH
-  TREE REMOVAL

CONSTRUCTION NOTES:

WATER VALVE ADJUSTMENTS TO GRADE ARE SUBSIDIARY TO CITY PROJECT UT1105DS WATERLINE INSTALLATION.

DATE	BY	REVISION



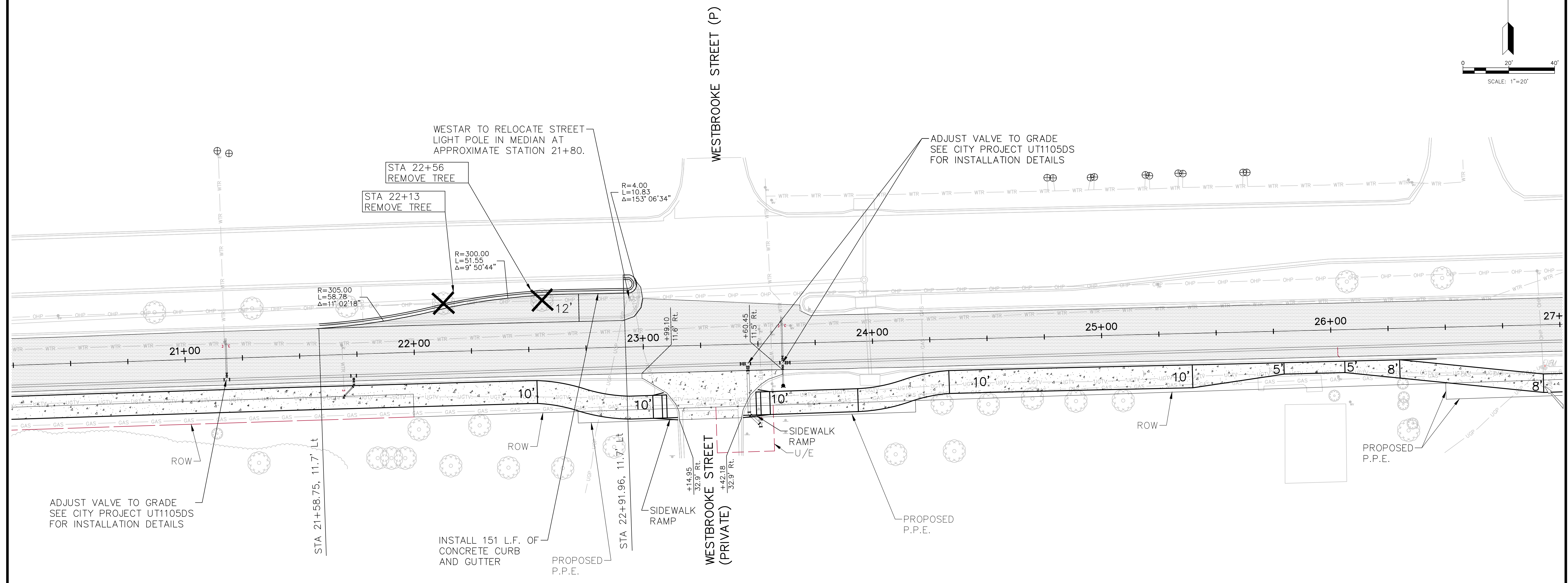
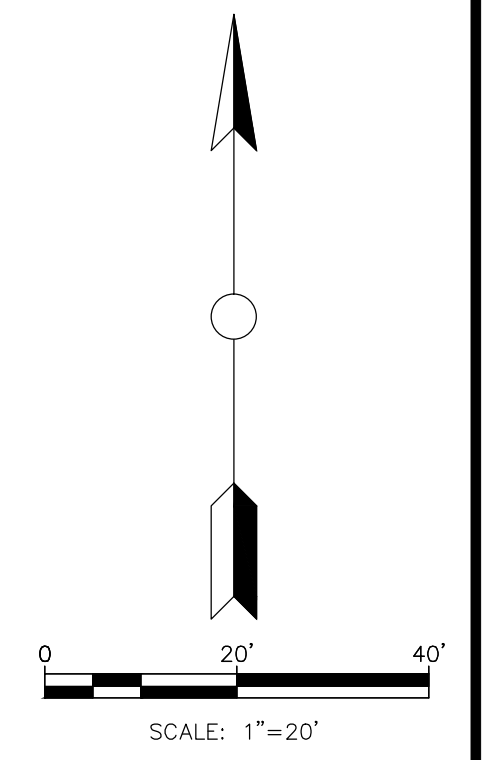

BOB BILLINGS PARKWAY, KASOLD DRIVE TO CRESTLINE DRIVE (EASTBOUND ONLY.)
PLAN SHEET
STA. 15+00 TO STA. 21+00
 PROJECT NO. PW1225

DAVID P. CRONIN CITY ENGINEER DAVID L. CORLISS CITY MANAGER



LEGEND

-  10" ASPHALT PAVEMENT (BASE) WITH 2" ASPHALT PAVEMENT (SURFACE)
-  6" REINFORCED CONCRETE SHARED USE PATH
-  TREE REMOVAL

CONSTRUCTION NOTES:

WATER VALVE ADJUSTMENTS TO GRADE ARE SUBSIDIARY TO CITY PROJECT UT1105DS WATERLINE INSTALLATION.

DATE	BY	REVISION



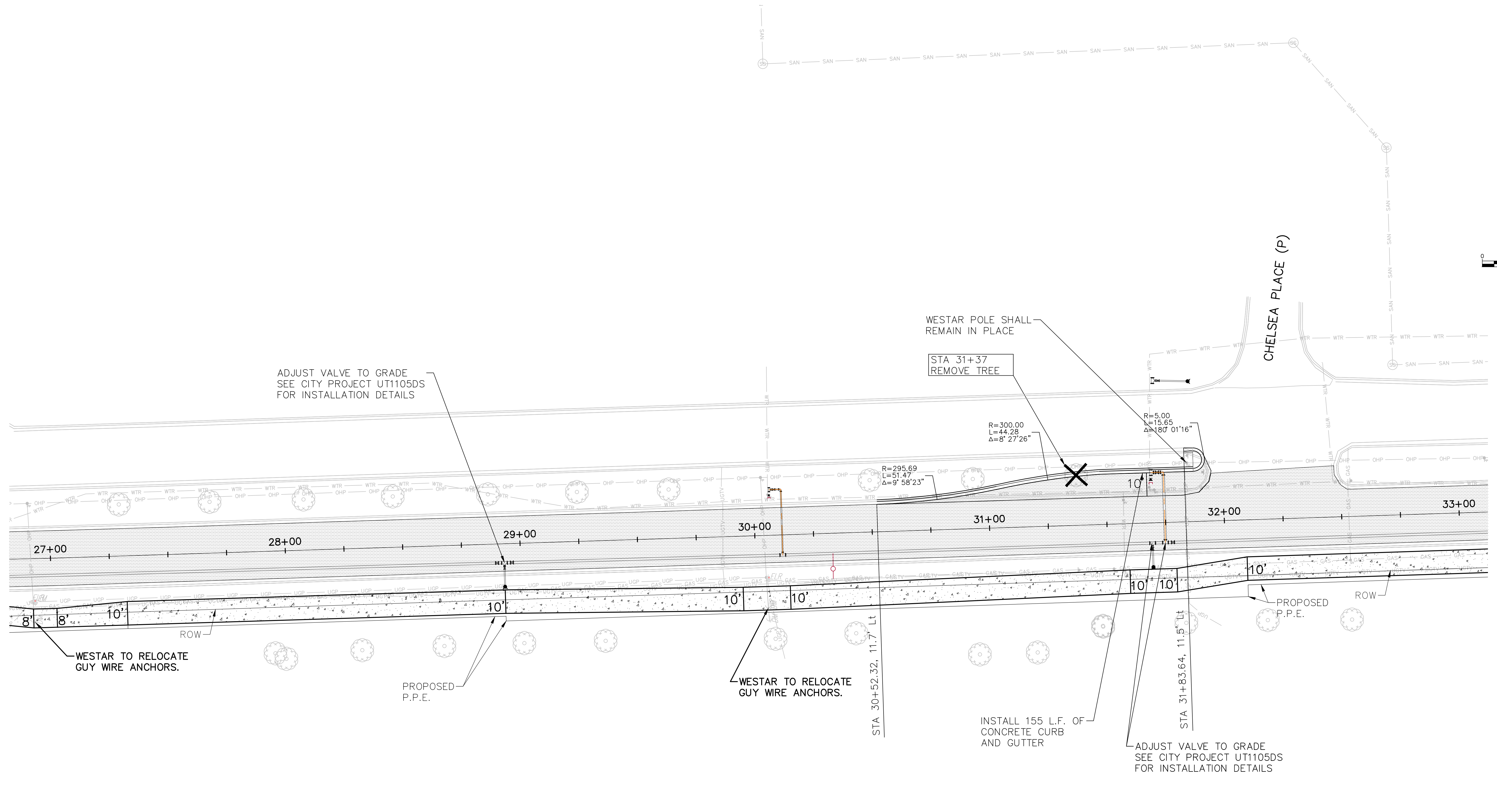
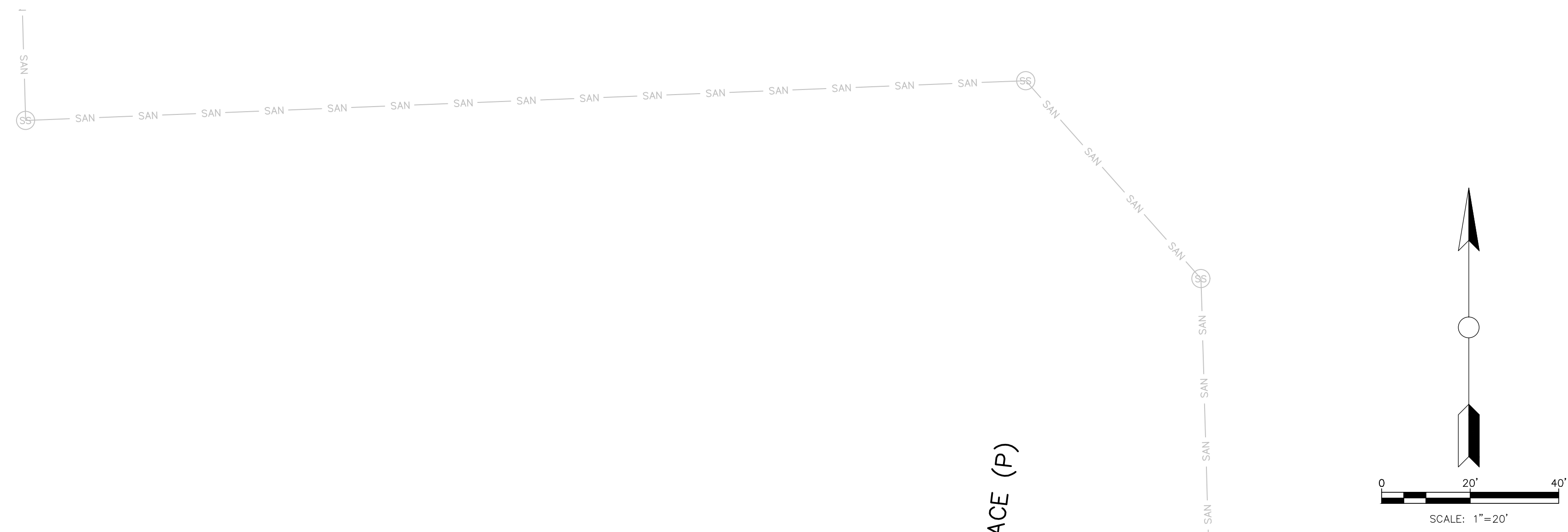

BOB BILLINGS PARKWAY, KASOLD DRIVE TO CRESTLINE DRIVE (EASTBOUND ONLY.)
PLAN SHEET
STA. 21+00 TO STA. 27+00
 PROJECT NO. PW1225

DAVID P. CRONIN CITY ENGINEER DAVID L. CORLISS CITY MANAGER

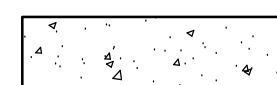

LEGEND

-  10" ASPHALT PAVEMENT (BASE) WITH 2" ASPHALT PAVEMENT (SURFACE)
-  6" REINFORCED CONCRETE SHARED USE PATH
-  TREE REMOVAL

CONSTRUCTION NOTES:

WATER VALVE ADJUSTMENTS TO GRADE ARE SUBSIDIARY TO CITY PROJECT UT1105DS WATERLINE INSTALLATION.

DATE	BY	REVISION



BOB BILLINGS PARKWAY, KASOLD DRIVE TO CRESTLINE DRIVE (EASTBOUND ONLY.)
PLAN SHEET
STA. 27+00 TO STA. 33+00
 PROJECT NO. PW1225

DAVID P. CRONIN CITY ENGINEER DAVID L. CORLISS CITY MANAGER

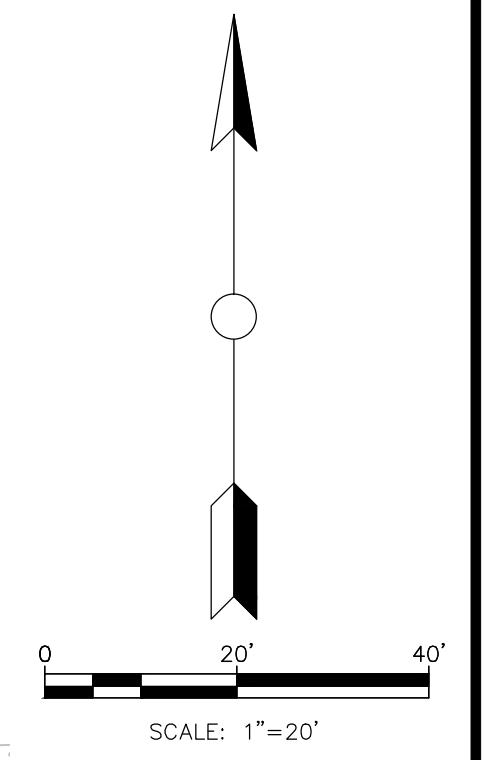
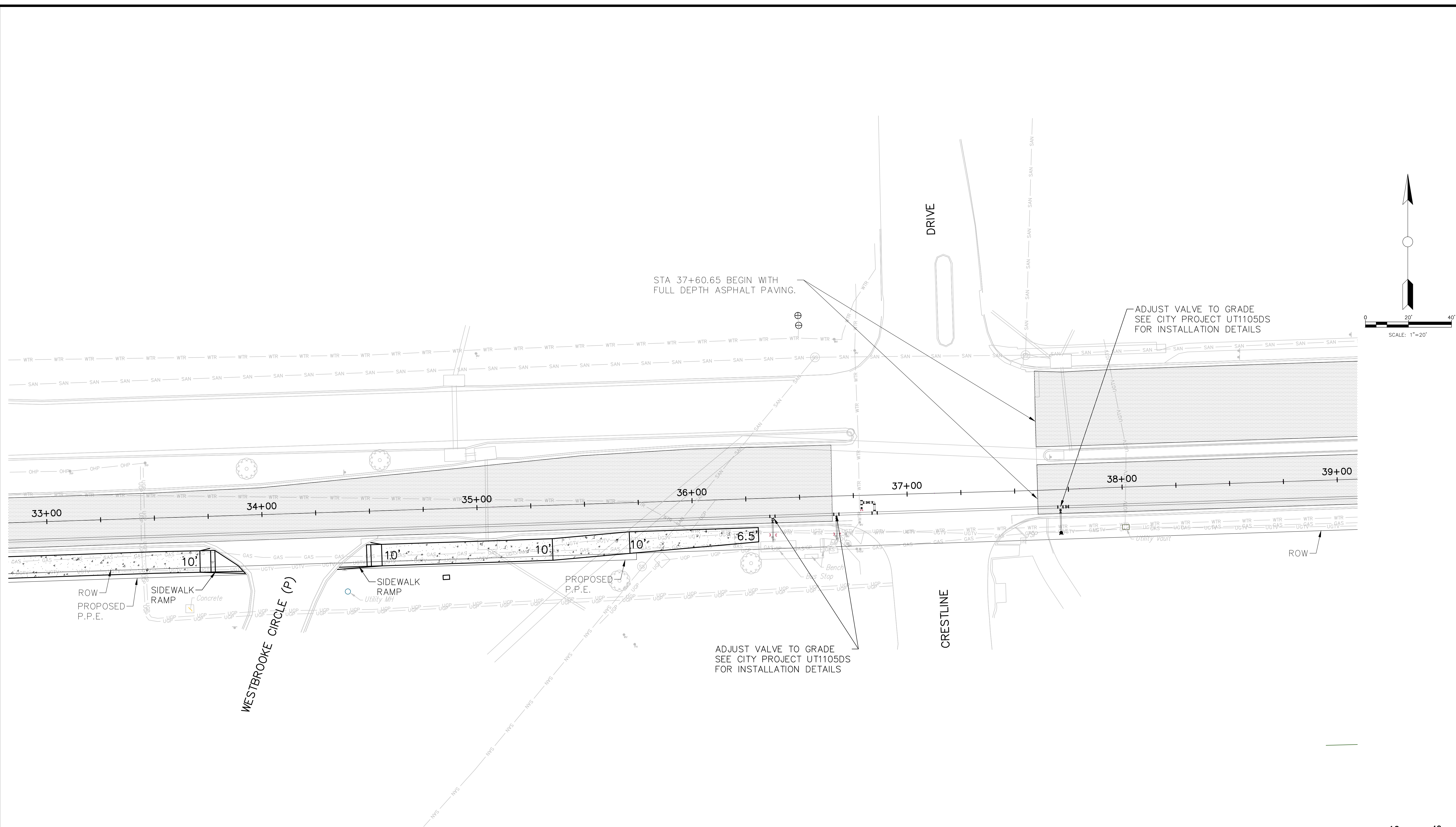

STA 37+60.65 BEGIN WITH
FULL DEPTH ASPHALT PAVING.

ADJUST VALVE TO GRADE
SEE CITY PROJECT UT1105DS
FOR INSTALLATION DETAILS

ADJUST VALVE TO GRADE
SEE CITY PROJECT UT1105DS
FOR INSTALLATION DETAILS

WESTBROOKE CIRCLE (P)

DRIVE

CRESTLINE

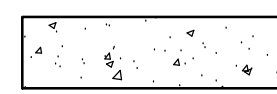
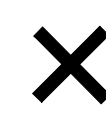
- LEGEND**
-  10" ASPHALT PAVEMENT (BASE)
WITH 2" ASPHALT PAVEMENT (SURFACE)
 -  6" REINFORCED CONCRETE
SHARED USE PATH
 -  TREE REMOVAL

CONSTRUCTION NOTES:
WATER VALVE ADJUSTMENTS TO GRADE ARE
SUBSIDIARY TO CITY PROJECT UT1105DS
WATERLINE INSTALLATION.

DATE	BY	REVISION



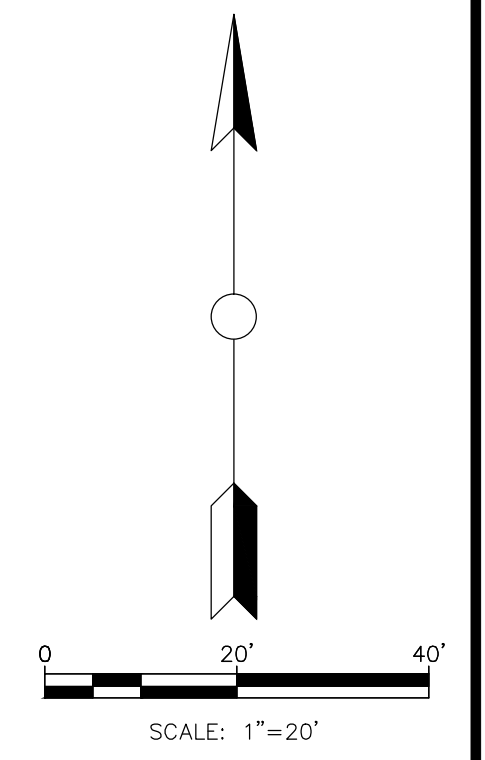
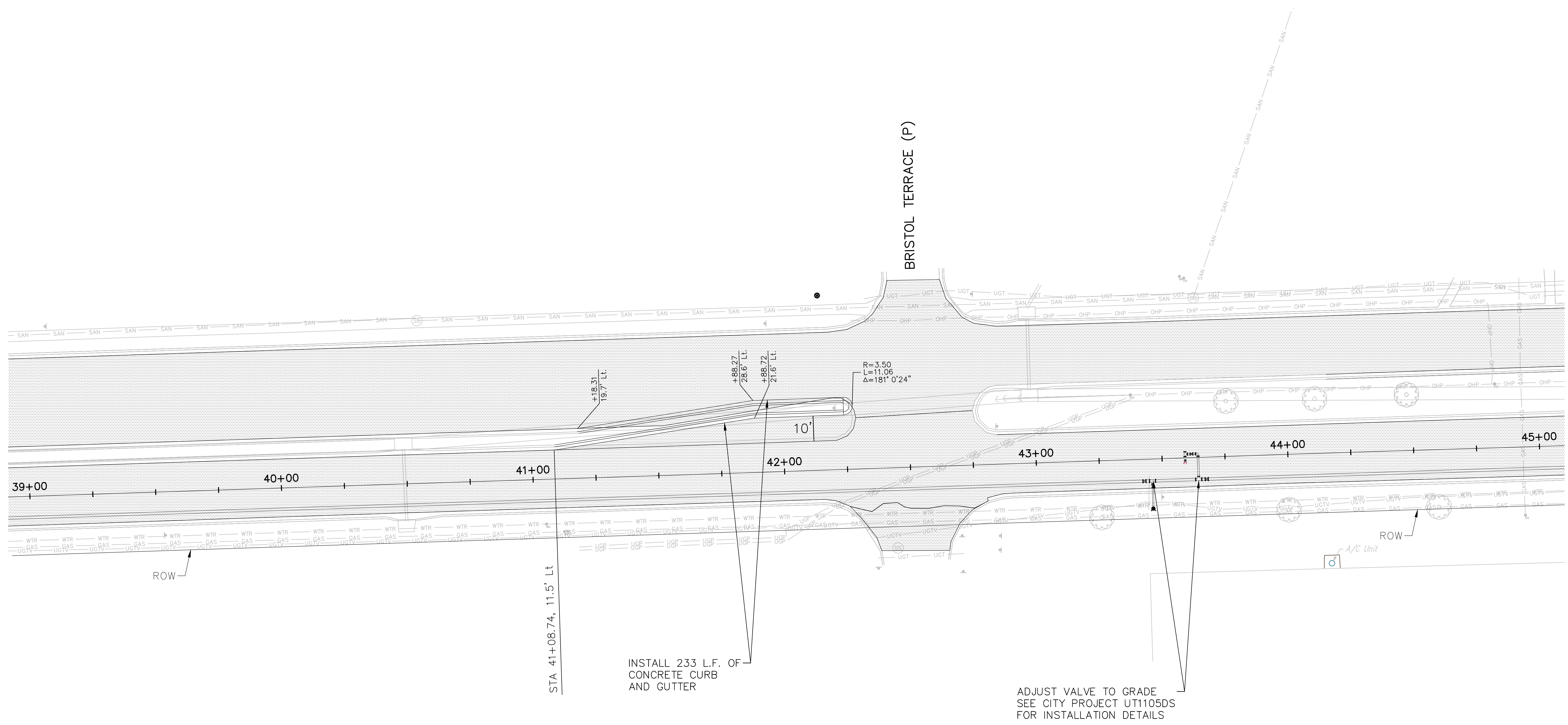

BOB BILLINGS PARKWAY, KASOLD DRIVE TO CRESTLINE DRIVE (EASTBOUND ONLY.)
PLAN SHEET
STA. 33+00 TO STA. 39+00
PROJECT NO. PW1225

DAVID P. CRONIN CITY ENGINEER DAVID L. CORLISS CITY MANAGER



SHEET 17 OF 40

LEGEND

-  10" ASPHALT PAVEMENT (BASE) WITH 2" ASPHALT PAVEMENT (SURFACE)
-  6" REINFORCED CONCRETE SHARED USE PATH
-  TREE REMOVAL

CONSTRUCTION NOTES:

WATER VALVE ADJUSTMENTS TO GRADE ARE SUBSIDIARY TO CITY PROJECT UT1105DS WATERLINE INSTALLATION.

DATE	BY	REVISION



BOB BILLINGS PARKWAY, KASOLD DRIVE TO CRESTLINE DRIVE (EASTBOUND ONLY.)
PLAN SHEET
STA. 39+00 TO STA. 45+00
 PROJECT NO. PW1225

DAVID P. CRONIN CITY ENGINEER DAVID L. CORLISS CITY MANAGER

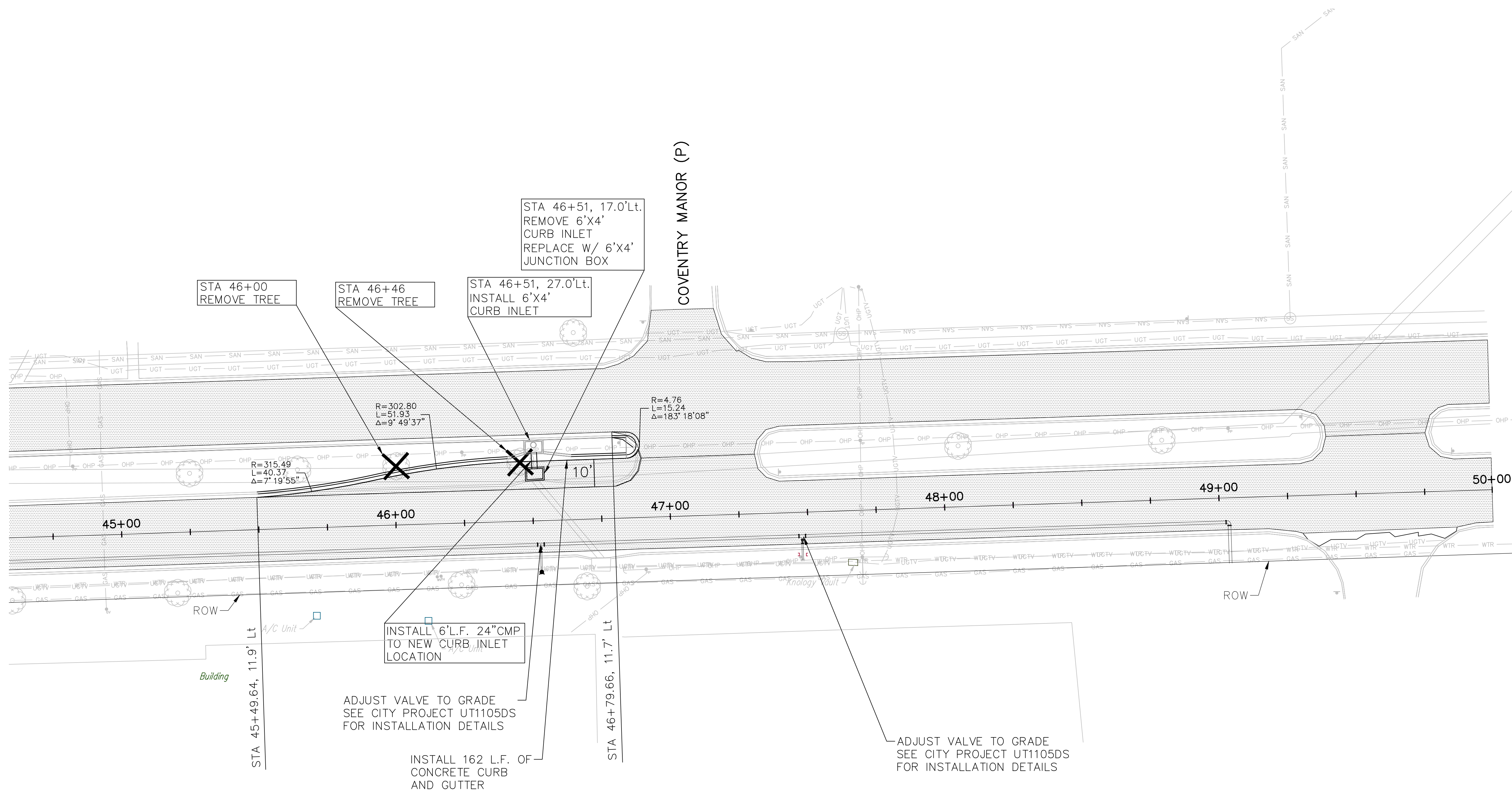
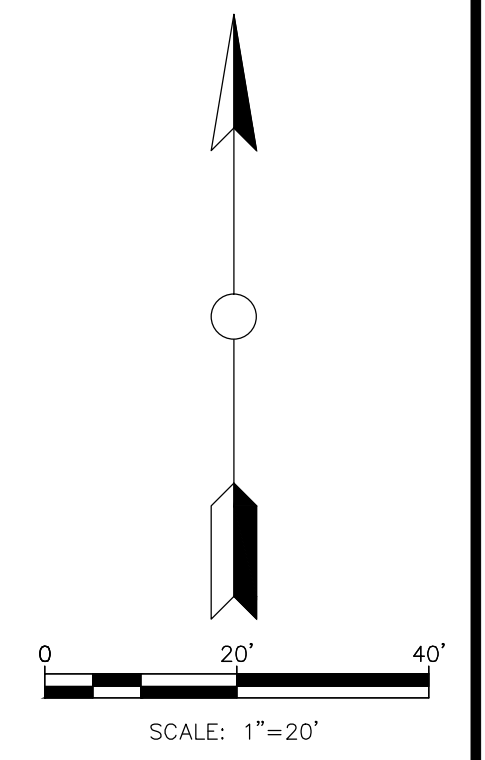

DATE	BY	REVISION



BOB BILLINGS PARKWAY, KASOLD DRIVE TO CRESTLINE DRIVE (EASTBOUND ONLY.)
PLAN SHEET
STA. 39+00 TO STA. 45+00
 PROJECT NO. PW1225

DAVID P. CRONIN CITY ENGINEER **DAVID L. CORLISS** CITY MANAGER

LEGEND

- 10" ASPHALT PAVEMENT (BASE) WITH 2" ASPHALT PAVEMENT (SURFACE)
- 6" REINFORCED CONCRETE SHARED USE PATH
- TREE REMOVAL

CONSTRUCTION NOTES:

WATER VALVE ADJUSTMENTS TO GRADE ARE SUBSIDIARY TO CITY PROJECT UT1105DS WATERLINE INSTALLATION.